

# SECTION 42L: PM3000-RV

AV PM3000  
STEREO INTERCOM

WH-00086  
PM3000-RV HARNESS

F-00028  
SV1000 INST  
PANEL LEFT

F-00030  
SKYVIEW REINF  
ANGLE

AV-50000A  
RV-12 CONTROL MODULE

**NOTE:** Throughout this section the F-00028 SV1000 Inst Panel Left (Key Sart) is shown. For installation of the SV-HDX1100 Display use the F-00028-1 HDX1100 Inst Panel Left. Installation is similar.

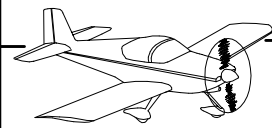

**Step 1:** Remove the hatched areas from the F-00030 SkyView Reinf Angle as shown in Figure 1.

**Step 2:** Machine countersink the #40 rivet attach holes in the aft face of the F-00028 SV1000 Inst Panel Left for the head of AN426AD3 rivets.

Machine countersink the #27 holes in the aft face of the SV1000 Inst Panel Left that are not associated with nutplates for the head of the screws called out in Figure 3. See Figure 2.

Final-Drill 1/4 the holes in the SV1000 Inst Panel Left and the Skyview reinf angle called out in Figure 2. Deburr.

Rivet the Skyview reinf angle to the SV1000 Inst Panel Left using the hardware called out in Figure 2.

**Step 3:** Rivet the nutplates to the F-00028 SV-1000 Inst Panel Left called out in Figure 2.

**Step 4:** Attach the F-00028 SV-1000 Inst Panel Left to the Fuselage Assembly using the hardware called out in Figure 3.

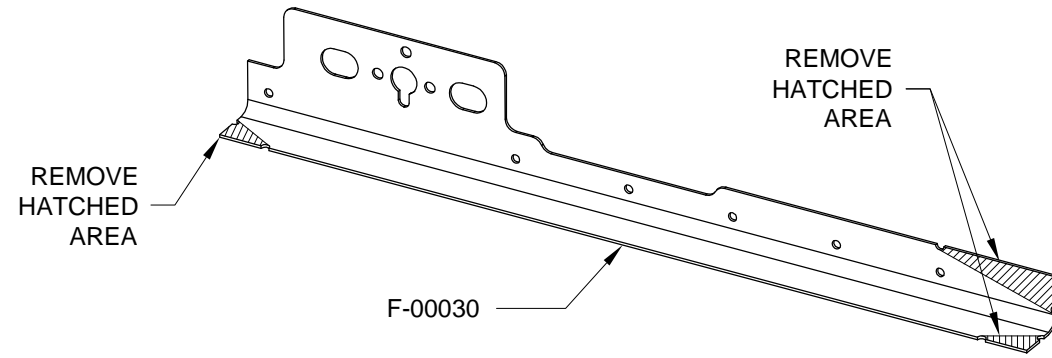

**FIGURE 1: MODIFYING REINF ANGLE**

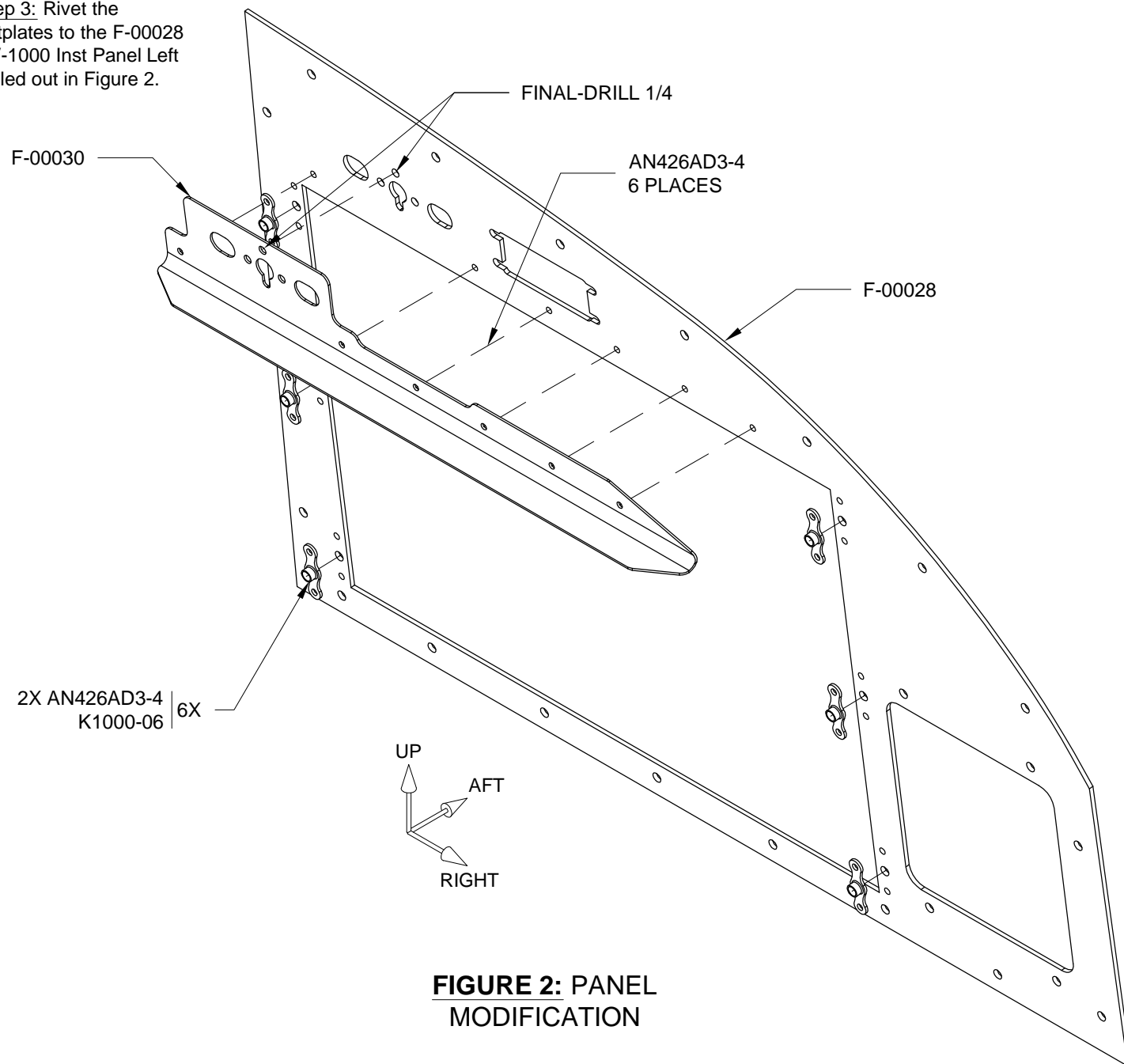

**FIGURE 2: PANEL MODIFICATION**

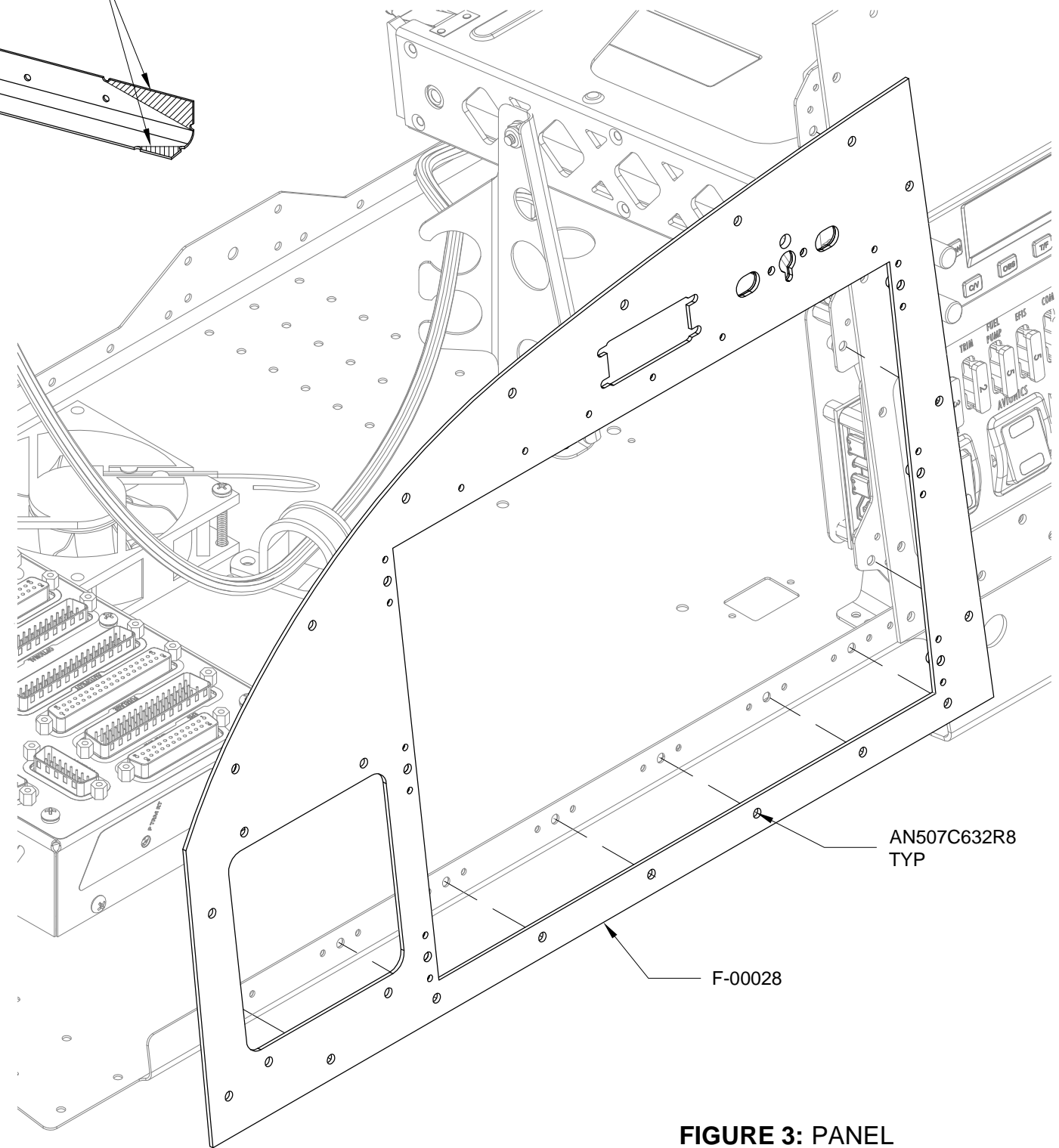

**FIGURE 3: PANEL INSTALLATION**

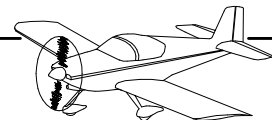

Step 1: Align the AV PM3000 Faceplate with the holes in the F-00028 SV-1000 Inst Panel Left as shown in Figure 1. The holes in the faceplate for the knobs align with the center of the outer arc on each of the knob holes in the instrument panel. Clamp the faceplate to the instrument panel.

Match-Drill 1/8 the two hole locations called out in Figure 1.

**NOTE: See instructions included with the AV PM3000 Stereo Intercom for additional installation instructions.**

Step 2: Install the AV PM3000 Stereo Intercom to the F-00028 SV-1000 Inst Panel Left as shown in Figure 2 ( **do not** enlarge the holes in the panel).

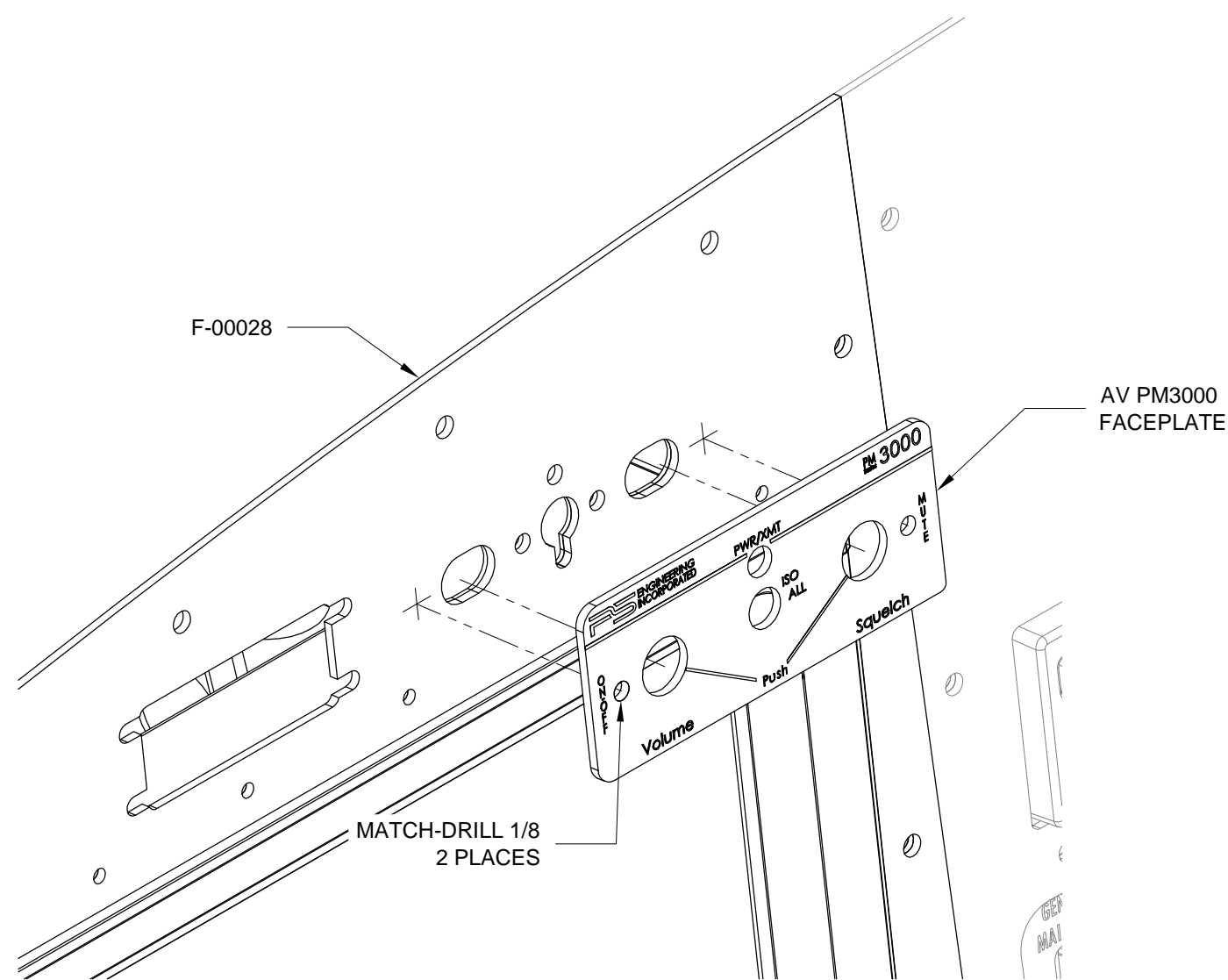

**FIGURE 1: LOCATING INTERCOM FACEPLATE**

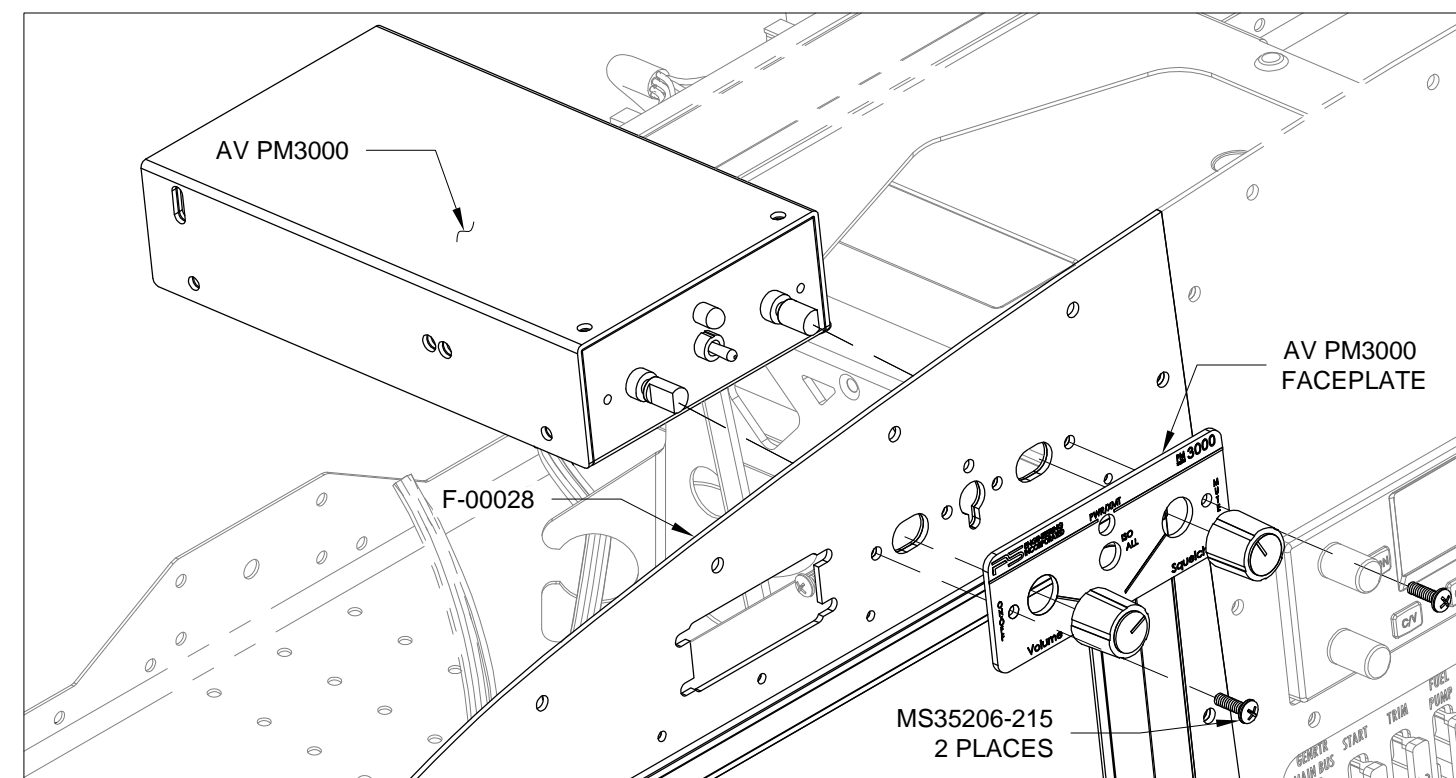

**FIGURE 2: INSTALLING THE INTERCOM**



Step 1: Install the 25-pin d-sub labeled "PM3000-RV" on the WH-00086 PM3000-RV Harness to the back of the AV PM3000 Intercom as shown in Figure 1.

Route the harness through the cushioned clamp near the ES-CPU FAN. See Figure 1.

Install the 37-pin d-sub labeled "INTERCOM" on the harness to the AV-50000A Control Module as shown in Figure 1.

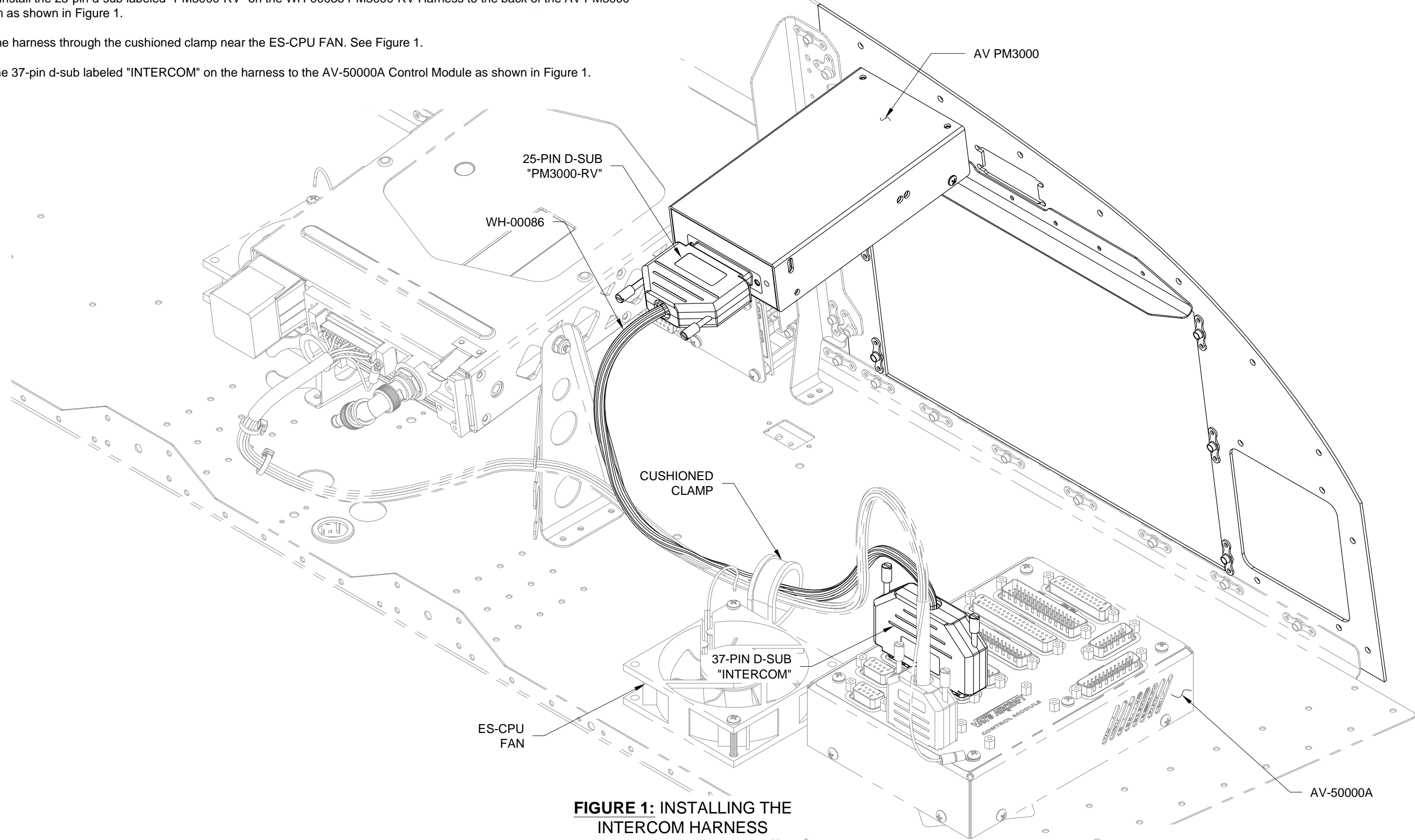

**FIGURE 1: INSTALLING THE INTERCOM HARNESS**