

SECTION 53: SKYVIEW ADS-B

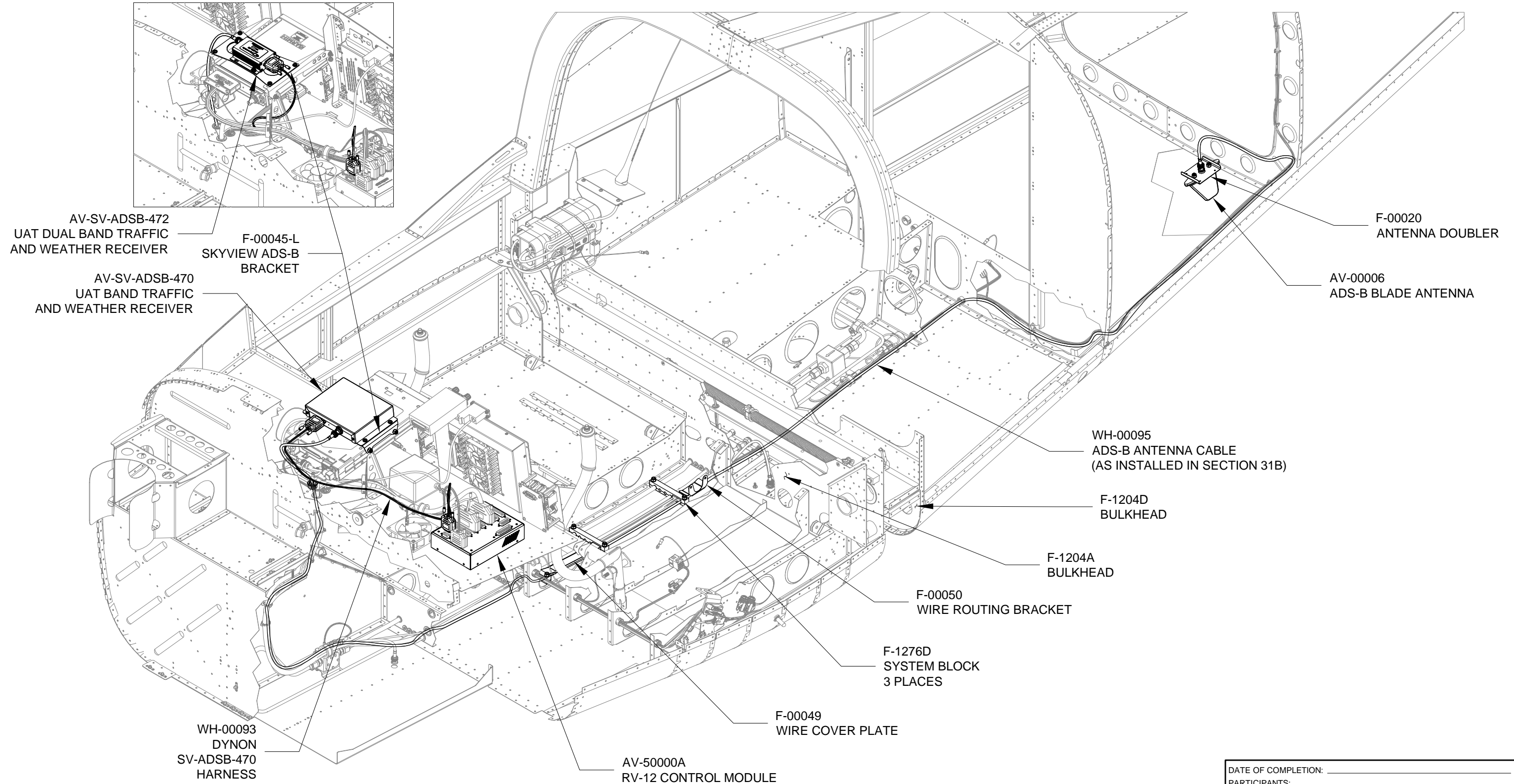

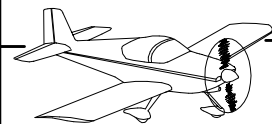

NOTE: If performing this installation on a completed aircraft refer to the Maintenance Manual Chapter 13 for instructions on draining the fuel tank.

Step 1: Remove the wings (if installed).

Remove the Top Cowl per Section 38.

Remove the F-1240 Upper Forward Fuselage Skin per Section 29A.

Remove the WH-P149 (WHT) Battery Ground Cable from the negative battery terminal per Section 45A.

Remove the Seats and Seat Backs.

Remove the F-1276B Cover Plates and Fuel Tank Assembly per Section 37.

Remove the F-1207F Baggage Bulkhead Corrugation per Section 26 and Section 33.

NOTE: The remaining steps on this page only apply if the WH-00095 ADS-B Antenna Cable is not yet installed. See Section 31B.

Step 2: Remove the F-1230 Tunnel Cover, Detent Bracket Assembly, F-1228 Seat Floor Cover, F-1229 Baggage Floor Cover and F-1206E Baggage Cover per Section 33.

Remove both Flaperon Pushrod Assemblies per Section 32.

Remove the Flap Handle/Pushrod Assembly and both F-1262 Flap Handle Blocks per Section 32.

Remove the upper F-1276C Systems Blocks per section 31B. Discard the blocks as they will be replaced with F-1276D Upper System Blocks.

Step 3: Move aside electrical, brake and control cable system routings on the upper and lower side of the F-1202B Panel Base in the area near the hole shown in Figure 1 that will be added to the panel base.

From the lower side drill #30 a pilot hole using the dimensions given in Figure 1.

If your drill / bit combination is too long to allow drilling normal to the surface of the panel base, temporarily remove the AV GARMIN SL40 Com Radio and tray then drill from the upper side. See Page 42C-07. Reinstall just the tray when finished.

Use a step drill to enlarge the #30 hole to 3/4. Check that the edges of the hole are deburred.

Step 4: Install a snap bushing into the hole made in Step 3.

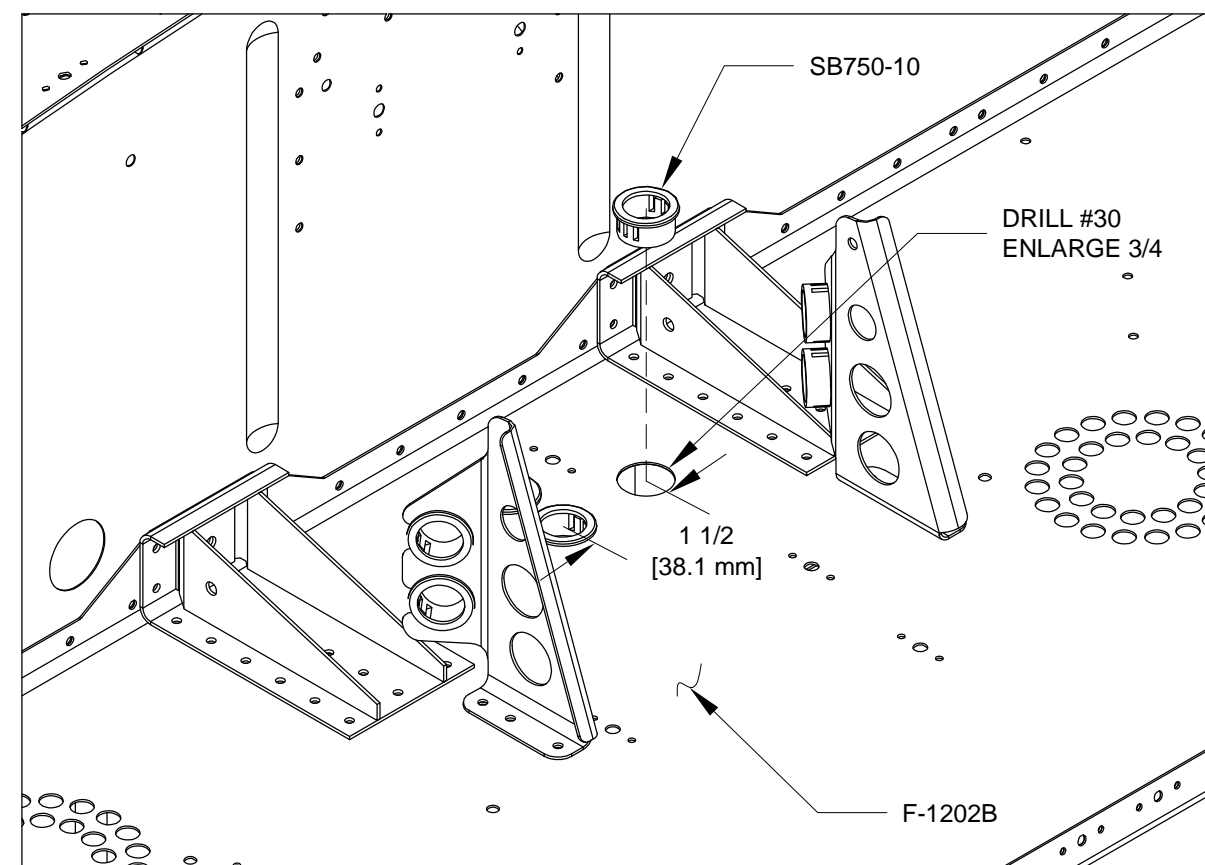
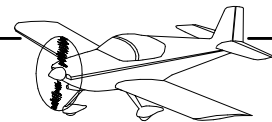

FIGURE 1: ADDING A WIRING HOLE TO THE PANEL BASE
(SOME PARTS NOT SHOWN FOR CLARITY)



NOTE: Steps 1 and 2 on this page only apply if the WH-00095 ADS-B Antenna Cable is not yet installed.

Step 1: Drill 3/4 and deburr a new wiring hole in the F-1204A Bulkhead as shown in Figure 1.

Install a snap bushing in the hole as shown in Figure 1.

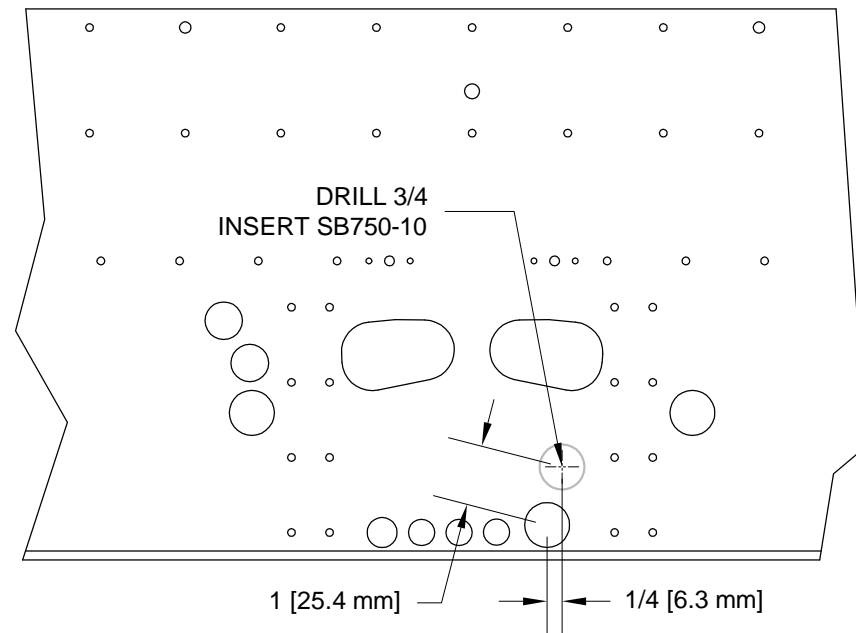

FIGURE 1: MODIFYING F-1204A
(FRONT CUTAWAY VIEW)

Step 2: Drill 3/4 and deburr a new wiring hole in the F-1204D Bulkhead as shown in Figure 2.

Install a snap bushing in the hole as shown in Figure 2.

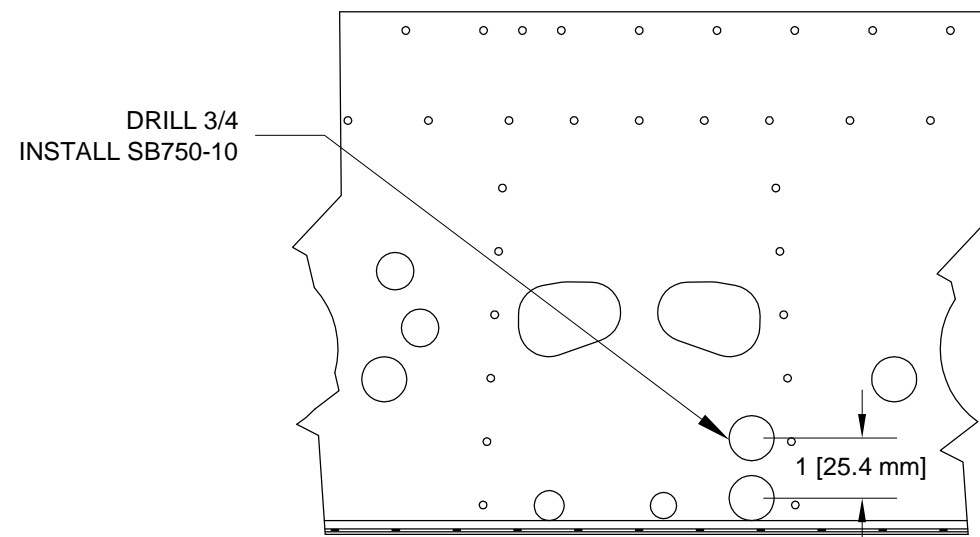

FIGURE 2: MODIFYING F-1204D
(FRONT CUTAWAY VIEW)

NOTE: Skip Step 3 and Step 4 if installing the Garmin GTR-200.

Step 3: Label and separate the F-00045-L & -R SkyView ADS-B Brackets as shown in Figure 3 by removing the hatched areas.

Deburr the edges of both parts.

Step 4: Machine countersink the nutplate attach holes in the F-00045-L & -R SkyView ADS-B Brackets as shown in Figure 3.

Rivet nutplates to the brackets using the hardware called out in Figure 3.

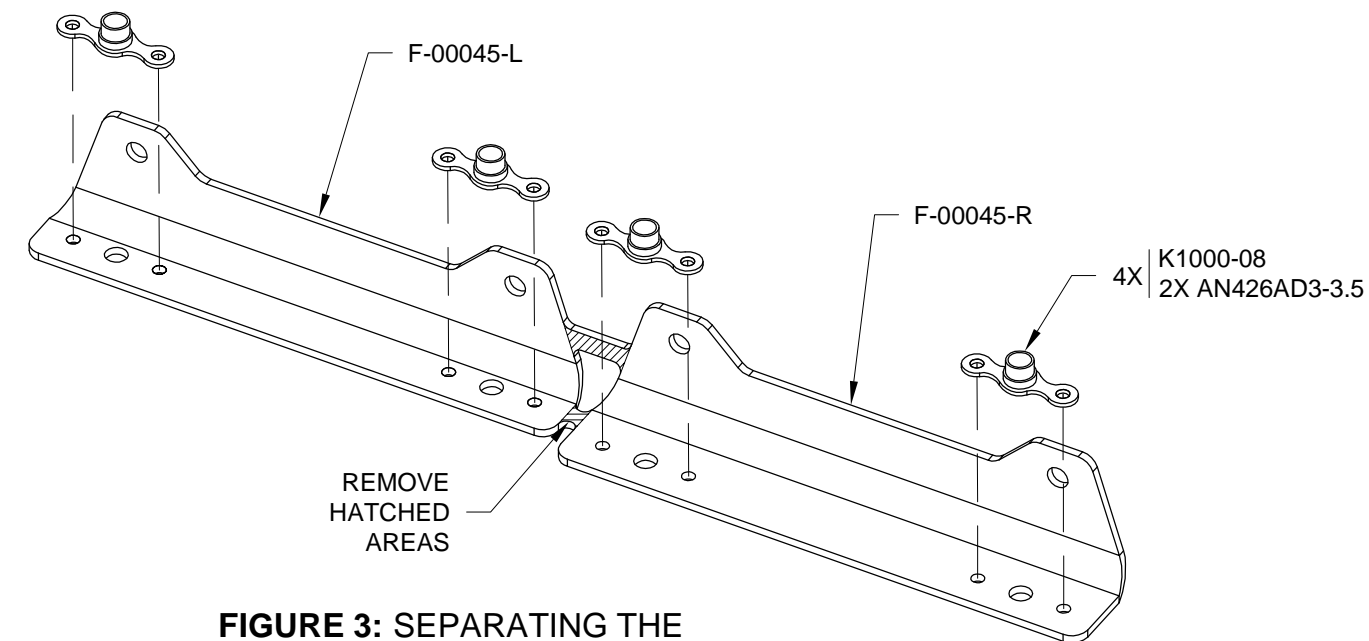

FIGURE 3: SEPARATING THE ADS-B BRACKETS

Step 5: Separate the F-00020 Antenna Doublers by removing the hatched area shown in Figure 4. Discard one part.

Deburr the edges of the remaining doubler.

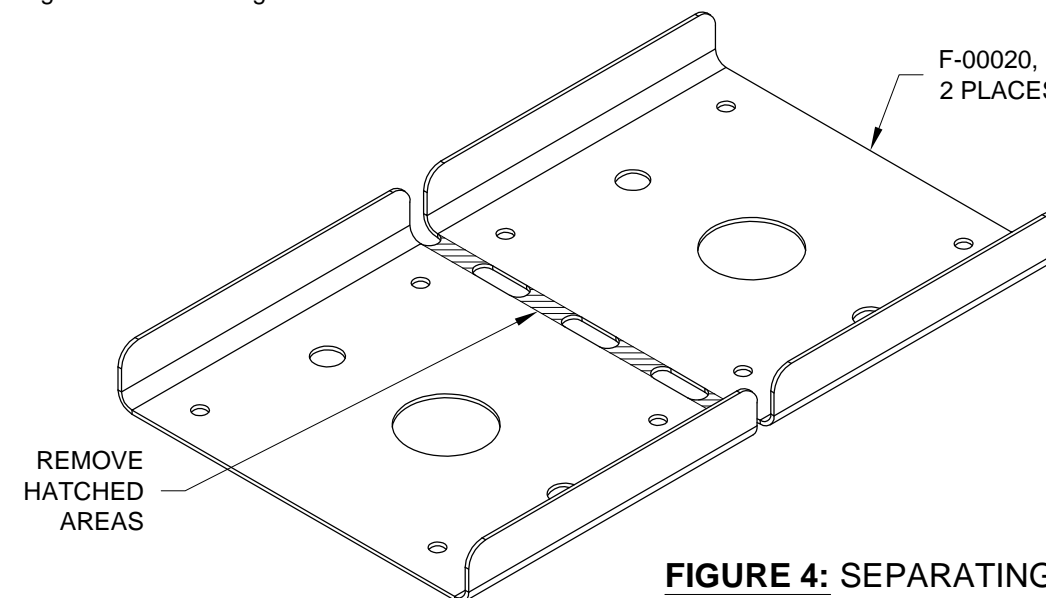
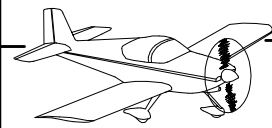

FIGURE 4: SEPARATING THE ANTENNA DOUBLERS



NOTE: This page covers the Garmin SL-40 installation. For Garmin GTR-200 installation skip to Page 53-05.

Step 1: Remove the AV GARMIN SL40 Com Radio from its tray. See Page 42C-07 and Figure 1.

Step 2: Install the F-00045-L & -R SkyView ADS-B Brackets to the AV GARMIN SL40 Com Radio Tray using the hardware called out in Figure 1.

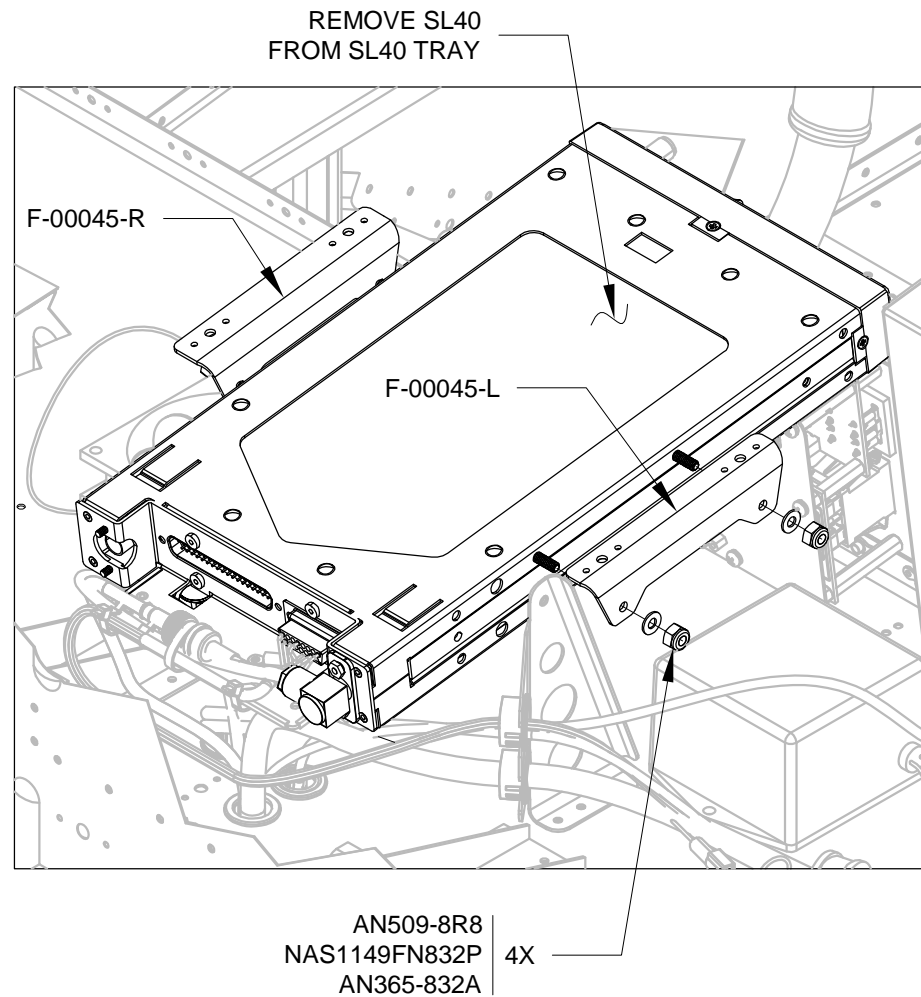

FIGURE 1: INSTALLING THE ADS-B BRACKETS

Step 3: Install the SV-ADSB-470 UAT Band Traffic and Weather Receiver to the F-00045-L & -R SkyView ADS-B Brackets using the hardware called out in Figure 2.

Step 4: Connect the WH-00093 SV-ADSB-470 Harness 9-pin d-sub with a WHT label to the SV-ADSB-470 UAT Band Traffic and Weather Receiver. See Figure 2.

Route the harness through a snap bushing in the F-00027-L Com Support and Cushioned Clamp near the left ES CPU FAN.

Connect the remaining 9-pin d-sub with a BLU label to the ADS-B Connector location on the AV-50000A RV-12 Control Module.

Step 5: Connect the end of the WH-00095 ADS-B Antenna Cable with the red band of heatshrink to the AV-SV-ADSB-470 UAT Band Traffic and Weather Receiver as shown in Figure 2.

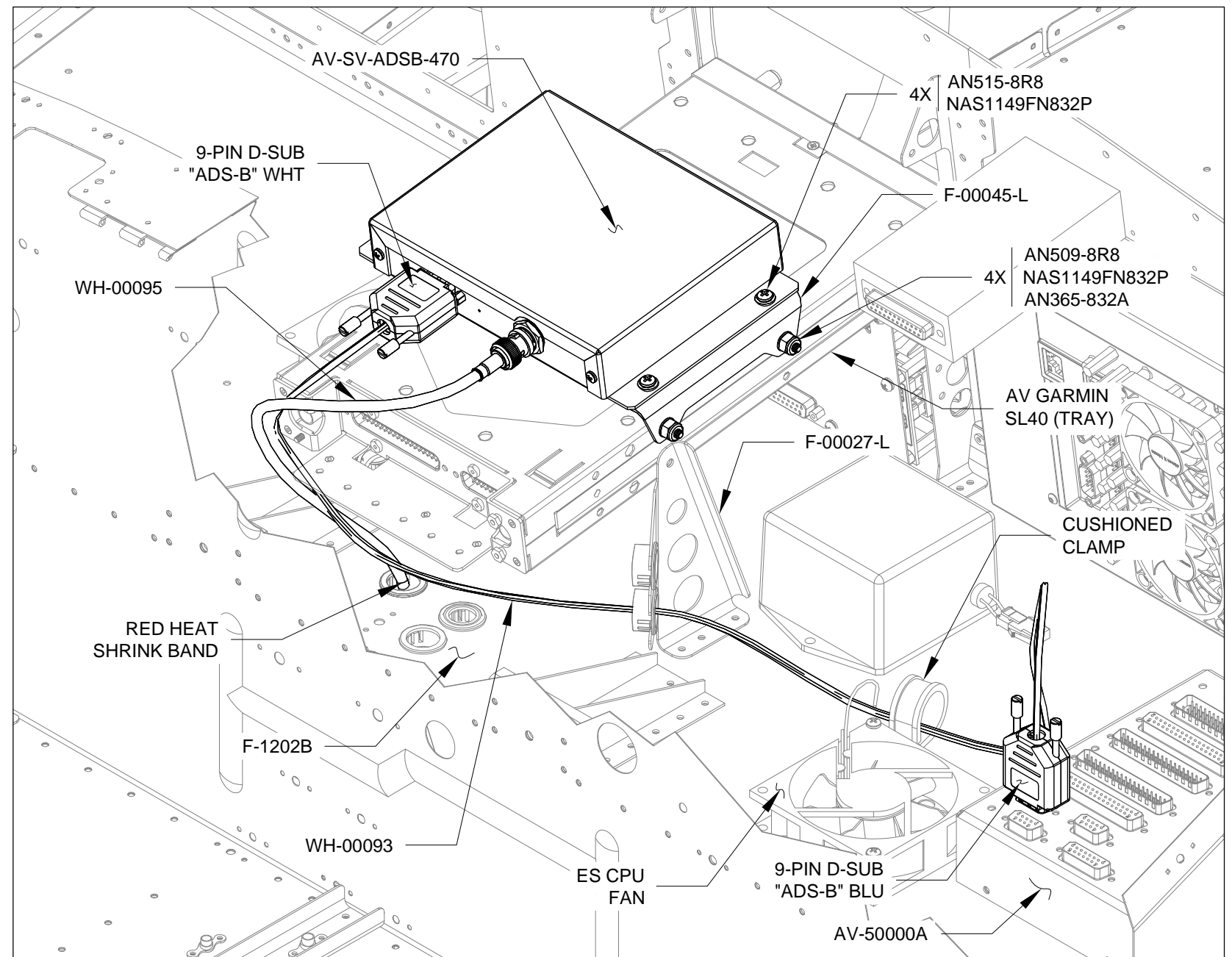
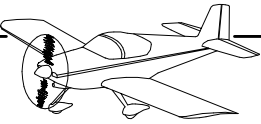

FIGURE 2: INSTALLING THE UAT RECEIVER



NOTE: This page covers the Garmin GTR-200 installation. For Garmin SL-40 installation skip to Page 53-07.

Step 1: Label and separate the F-00045B-L & -R Garmin ADS-B Brackets as shown in Figure 1 by removing the hatched areas.

Deburr the edges of both parts.

Step 2: Machine countersink the nutplate attach holes in the F-00045B-L & -R Garmin ADS-B Brackets as shown in Figure 1.

Rivet nutplates to the brackets using the hardware called out in Figure 1.

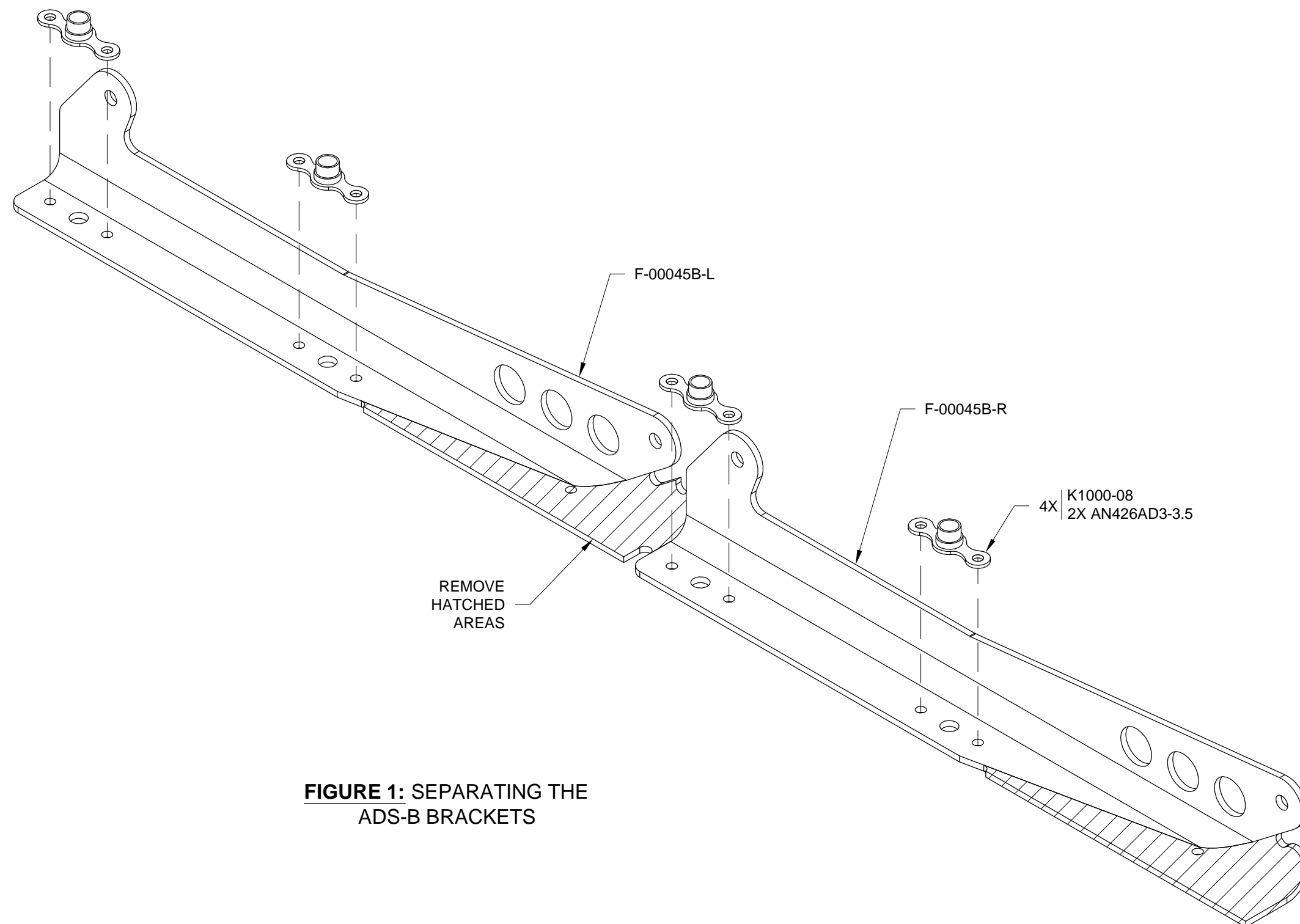

**FIGURE 1: SEPARATING THE
ADS-B BRACKETS**



NOTE: This page covers the Garmin GTR-200 installation.

Step 1: Remove the AV GARMIN GTR200 Com Radio from its tray. See Page 42G-03 and Figure 1.

Step 2: Install the F-00045B-L & -R GARMIN ADS-B Brackets to the AV GARMIN GTR200 Com Radio Tray using the hardware called out in Figure 1.

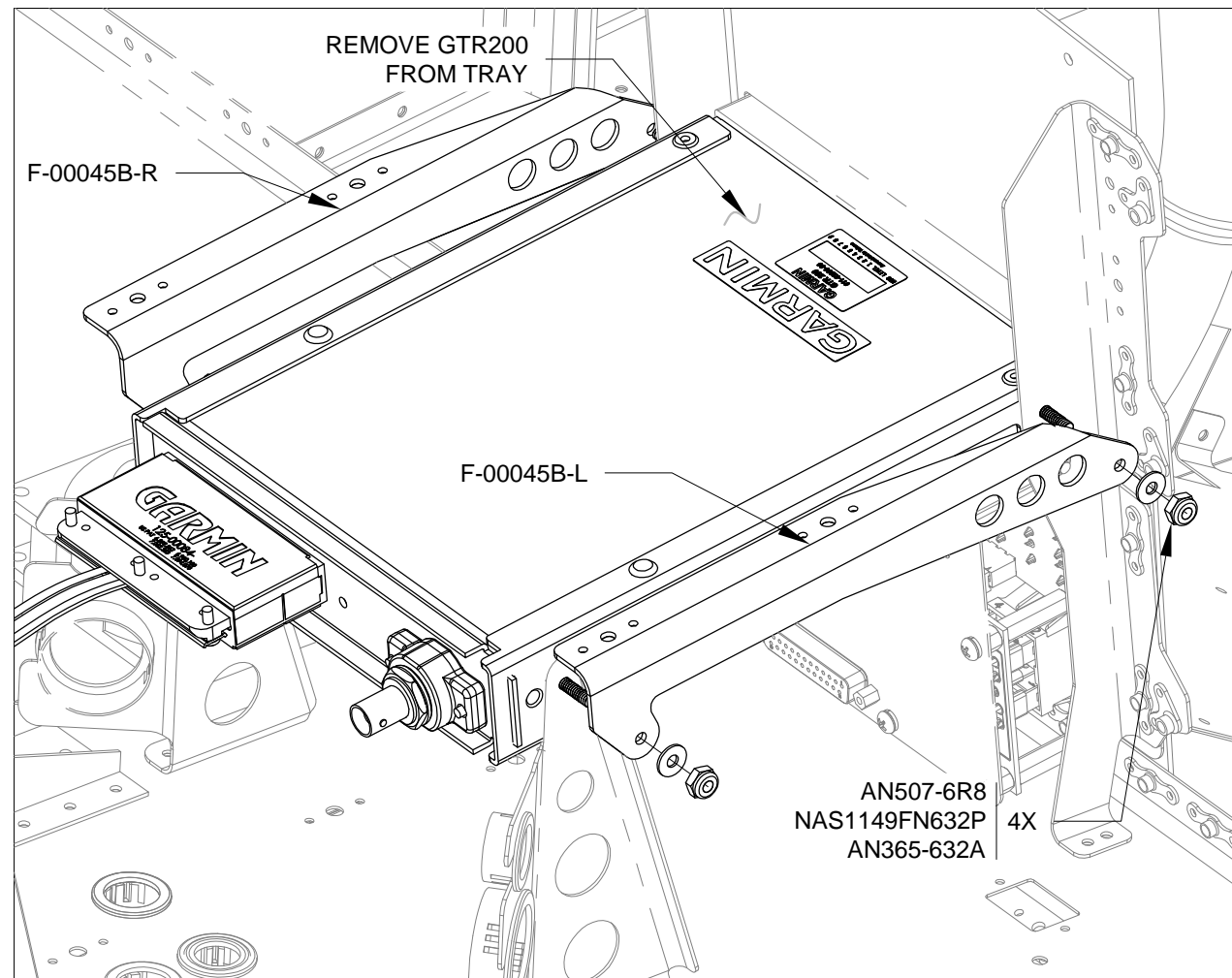
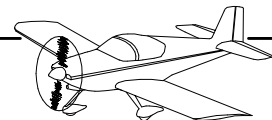

FIGURE 1: INSTALLING THE ADS-B BRACKETS



NOTE: This page covers installation of AV-SV-ADSB-470.

Step 1 (ADS-B 470): Install the SV-ADSB-470 UAT Band Traffic and Weather Receiver to the F-00045B-L & -R GARMIN ADS-B Brackets using the hardware called out in Figure 1.

Step 2 (ADS-B 470): Connect the WH-00093 SV-ADSB-470 Harness 9-pin d-sub with a WHT label to the SV-ADSB-470 UAT Band Traffic and Weather Receiver. See Figure 1.

Route the harness through a snap bushing in the F-00055-L Com Support GTR-200 and Cushioned Clamp near the left ES CPU FAN.

Connect the remaining 9-pin d-sub with a BLU label to the ADS-B Connector location on the AV-50000A RV-12 Control Module.

Step 3 (ADS-B 470): Connect the end of the WH-00095 ADS-B Antenna Cable with the red band of heatshrink to the AV-SV-ADSB-470 UAT Band Traffic and Weather Receiver as shown in Figure 1.

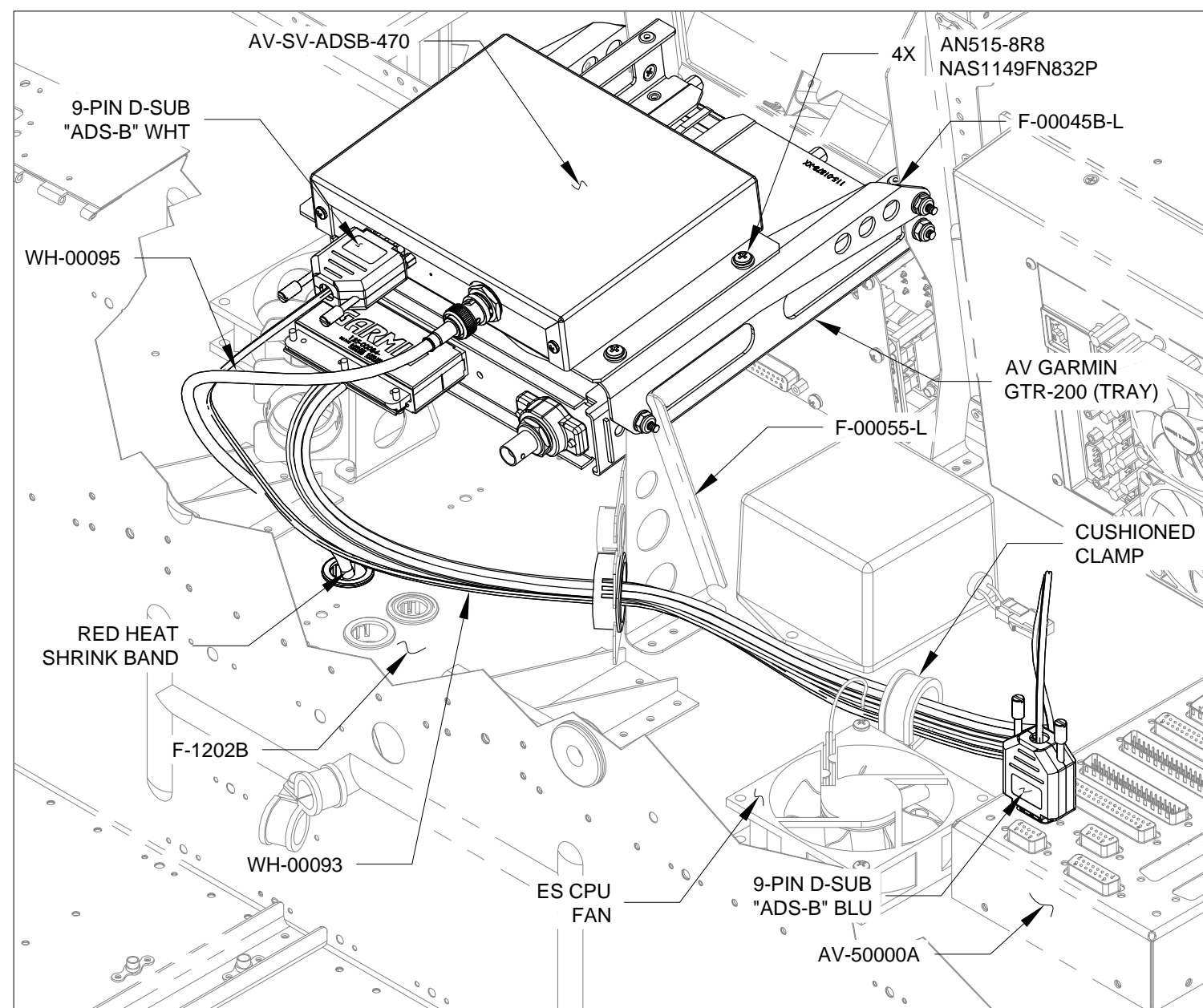
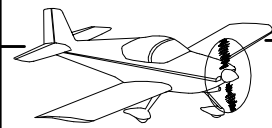

FIGURE 1: INSTALLING THE UAT RECEIVER



NOTE: This page covers installation of AV-SV-ADSB-472.

Step 1 (ADS-B 472): Attach SV-ADSB-472 to F-00045C as shown in Figure 1.

Step 2 (ADS-B 472): Attach F-00045C to F-00045B-L & -R as shown in Figure 1.

Step 3 (ADS-B 472): Connect the WH-00093 SV-ADSB-470 Harness 9-pin d-sub with a WHT label to the SV-ADSB-472 UAT Dual Band Traffic and Weather Receiver. See Figure 1.

Route the harness through a snap bushing in the F-00055-L Com Support GTR-200 and Cushioned Clamp near the left ES CPU FAN.

Connect the remaining 9-pin d-sub with a BLU label to the ADS-B Connector location on the AV-50000A RV-12 Control Module.

Step 4 (ADS-B 472): Connect the end of the WH-00095 ADS-B Antenna Cable with the red band of heatshrink to the AV-SV-ADSB-470 UAT Band Traffic and Weather Receiver as shown in Figure 1.

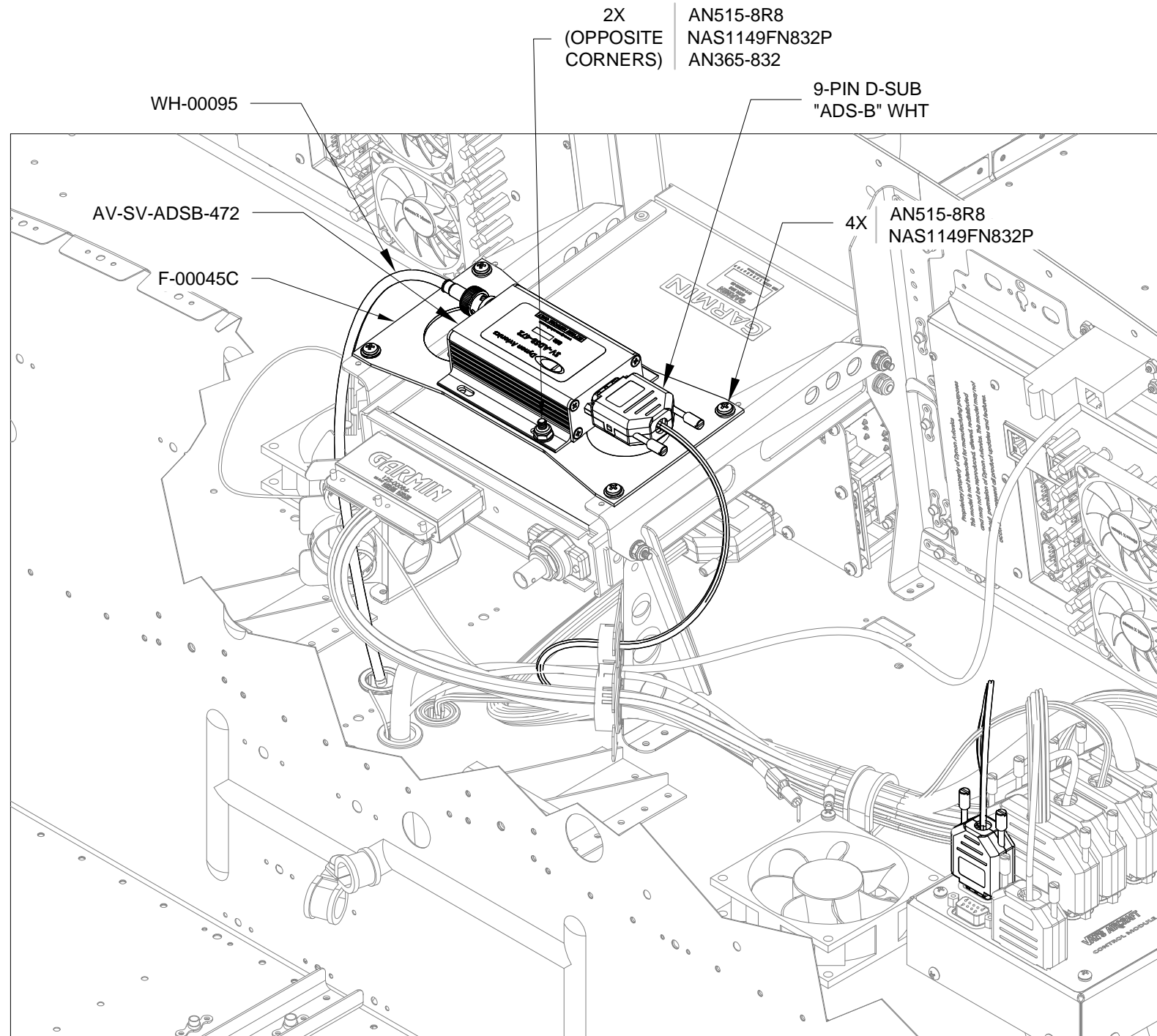
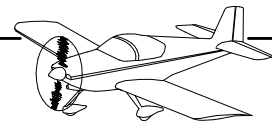

FIGURE 1: INSTALLING THE UAT DUAL BAND RECEIVER



NOTE: The steps on this page only apply if the WH-00095 ADS-B Antenna Cable is not yet installed. See Section 31B.

Step 1: Use a bench vice and plastic hammer to bend the F-00049 Wire Cover Plate flanges as shown in Figure 1.

Bend the wire cover plate by hand as necessary to cover the wires as shown in Figures 1 and 2.

Step 2: Route the free end of the WH-00095 ADS-B Antenna Cable through the snap bushing added to the F-1202B Panel Base on Page 53-02. Align the red band of heat shrink with the snap bushing. Tie-wrap the cable to the WH-00050 Transponder Antenna Cable (see Page 42C-09).

Step 3: Loosen the fasteners holding the rudder pedals and wire way, lowering them slightly to allow room for a BNC connector to pass between the pedals and the firewall through the F-12125 Over Rudder Wireway (see Page 31B-25). Pass the WH-00095 ADS-B Antenna Cable through the space then tighten the rudder pedals and wireway back into place.

Step 4: Route WH-00095 ADS-B Antenna Cable through the cushioned clamp next to the fuel flow sender as shown in Figure 3.

Using Figure 2 and Section 31B as reference route the cable through the upper snap bushings for wire routing in the F-1202F and F-1203A Bulkheads.

Route the cable through the F-1276C Systems Blocks then install the F-00049 Wire Cover Plate and the F-1276D System Blocks. Adjust the wire cover plate to avoid any interference with adjacent parts.

Step 5: Route WH-00095 ADS-B Antenna Cable aft through the upper snap bushings just added to the F-1204A and F-1204D Bulkheads, through the cushioned clamp near the fuel pump, and through the openings in the F-1206A and F-1207B Bulkheads as shown in Figure 3.

Secure the ADS-B Antenna Cable to the F-1206F Bearing Bracket Brace and other wires as shown in Figure 3.

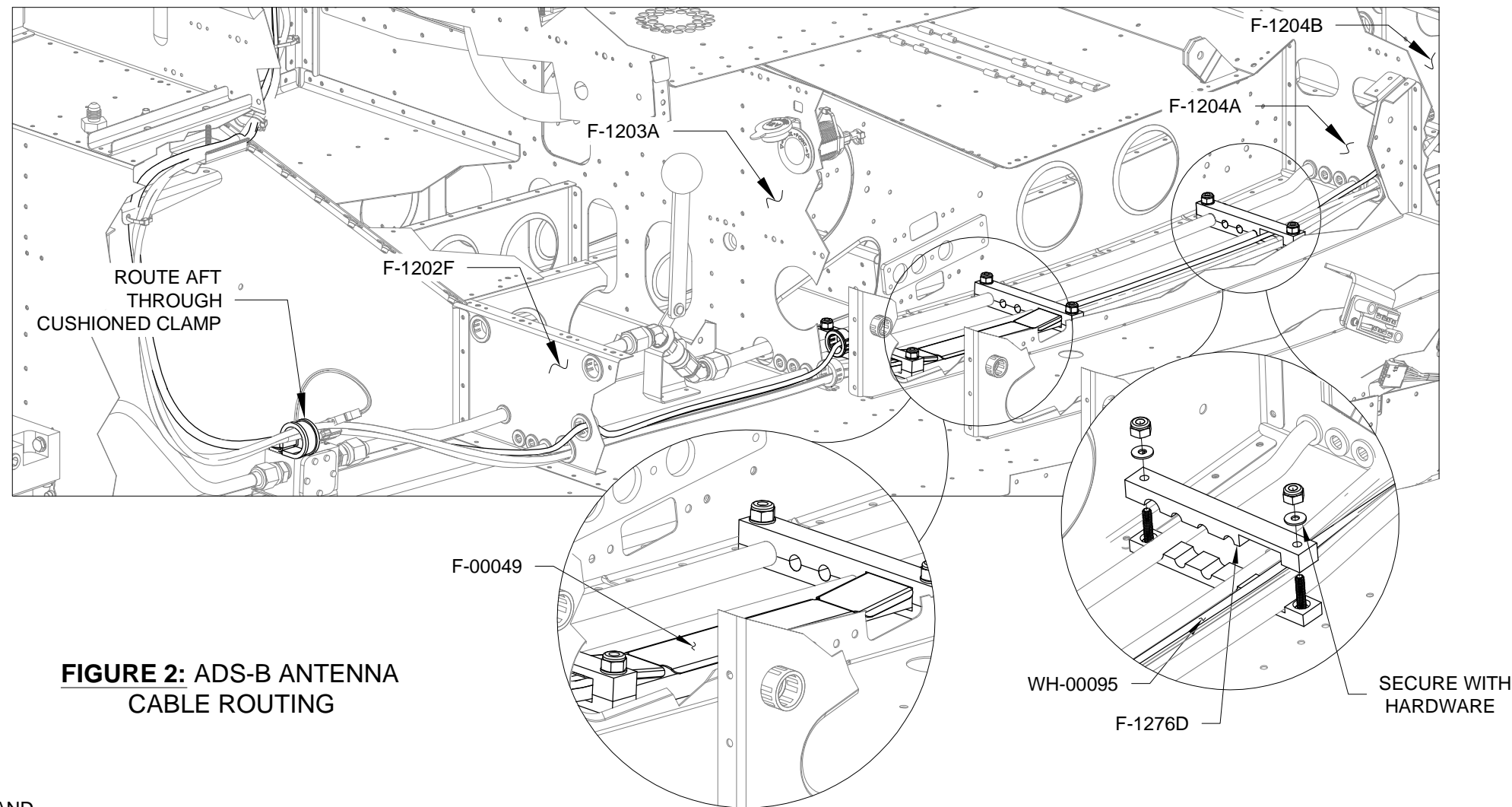

FIGURE 2: ADS-B ANTENNA CABLE ROUTING

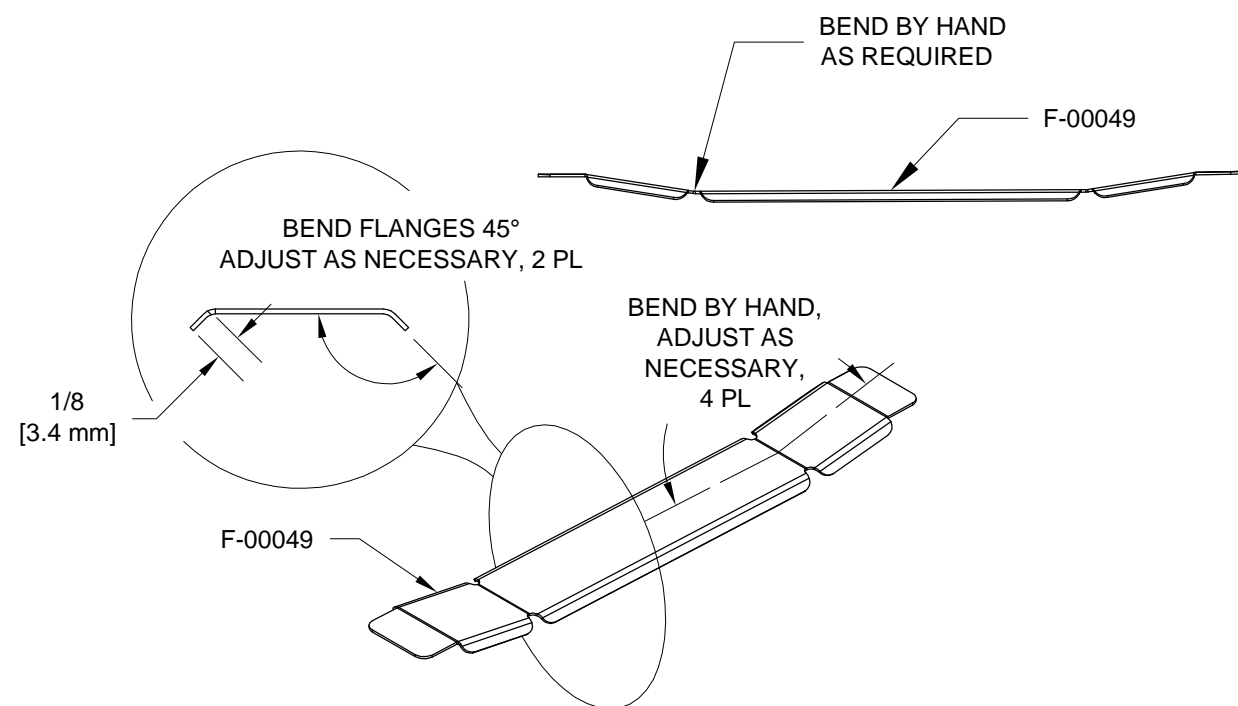

FIGURE 1: BENDING WIRE COVER PLATE

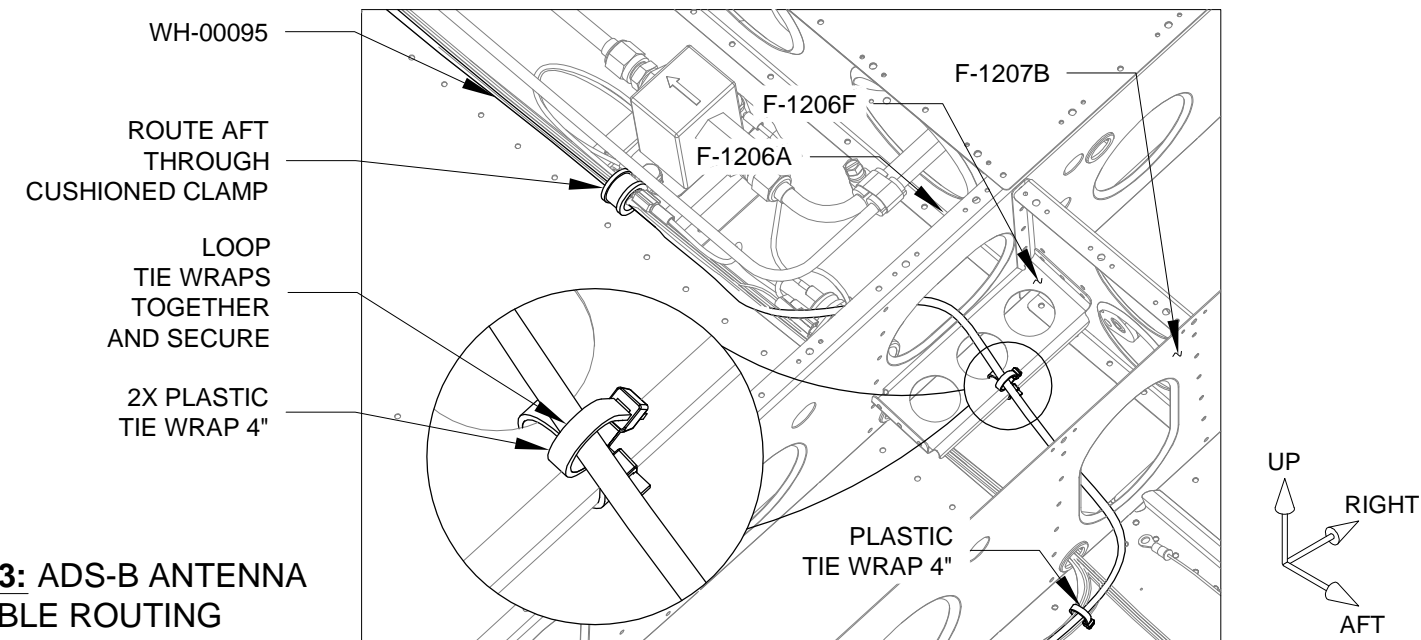

FIGURE 3: ADS-B ANTENNA CABLE ROUTING

NOTE: The steps on this page only apply if the WH-00095 ADS-B Antenna Cable is not yet installed. See Section 31B.

Step 1: Remove the hatched area as shown in Figure 1 to leave one F-1016HX Guide Bracket.

Step 2: Position F-1016HX Guide Bracket on the inboard flange of the F-1207D-L Baggage Bulkhead Channel with the forward edge of the bracket even with the start of the bend in the flange of the channel. See Figure 2.

Position guide bracket vertically approximately as shown in Figure 2 (exact position is not critical).

Step 3: Use a 12" long #30 drill to match-drill #30 both holes in the F-1016HX Guide Bracket into the flange of the F-1207D-L Baggage Bulkhead Channel.

Step 4: Remove the F-1016HX Guide Bracket.

Deburr the holes in the bracket and channel.

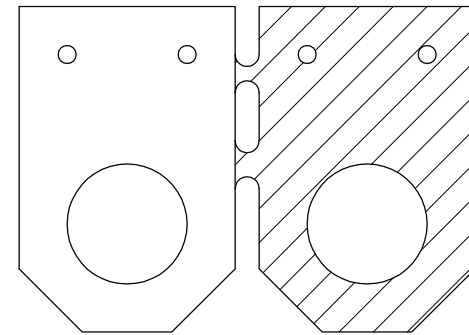

FIGURE 1: SPLITTING APART THE GUIDE BRACKETS

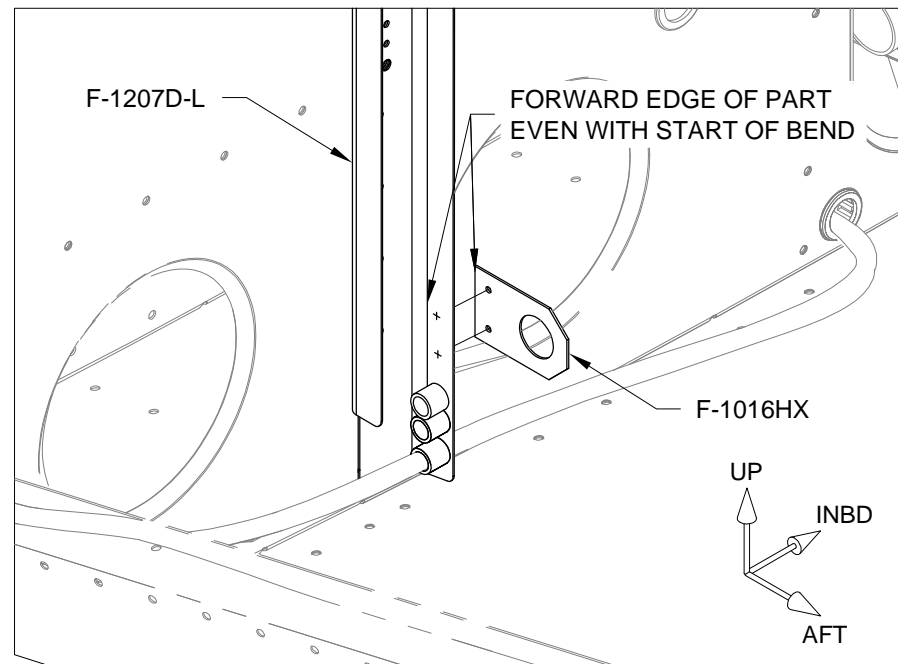

FIGURE 2: MATCH-DRILLING THE GUIDE BRACKET

Step 5: Rivet F-1016HX Guide Bracket to F-1207D-L Baggage Bulkhead Channel per the callouts in Figure 3.

Step 6: Route the WH-00095 ADS-B Antenna Cable through the hole in the bracket. Make a slit in the snap bushing, wrap it around the ADS-B antenna cable, and insert in the guide bracket as shown in Figure 3.

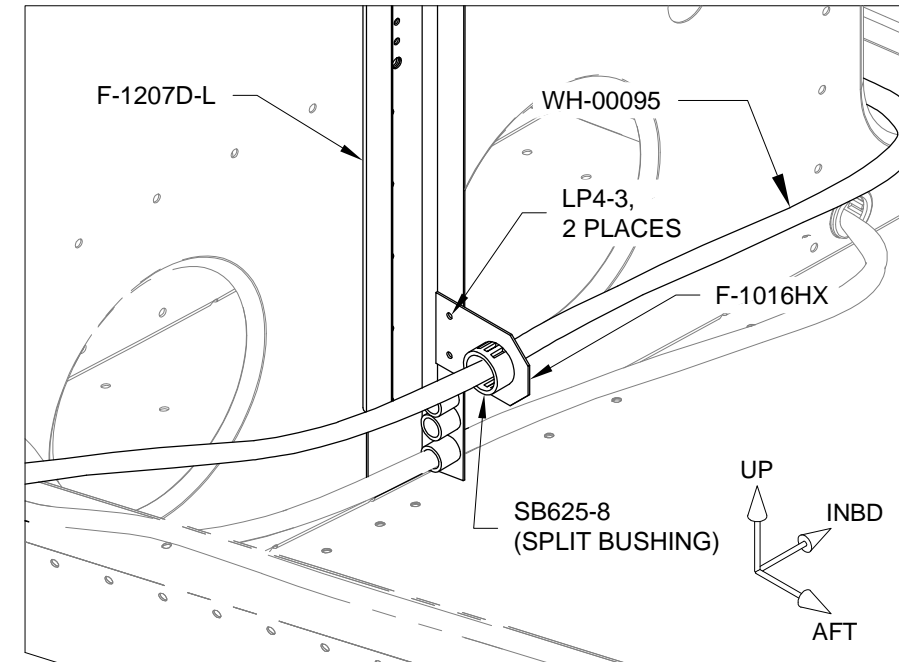
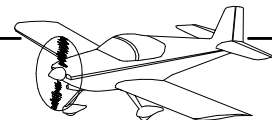

FIGURE 3: INSTALLING THE GUIDE BRACKET



Step 1: Position the F-00020 Antenna Doubler on the F-1282-L Bottom Left Skin as shown in Figure 1.

Match-Drill #30 and cleco the four .098 holes in the doubler into the skin.

Match-Drill 3/16 the two holes in the doubler into the skin.

Drill #30 the center of the middle hole as shown in Figure 1. Final-Drill 9/16 the center hole in the skin.

Remove the doubler and deburr the holes in both the doubler and skin.

Step 2: Rivet the F-00020 Antenna Doubler to the F-1282-L Bottom Left Skin using the rivets called out in Figure 1.

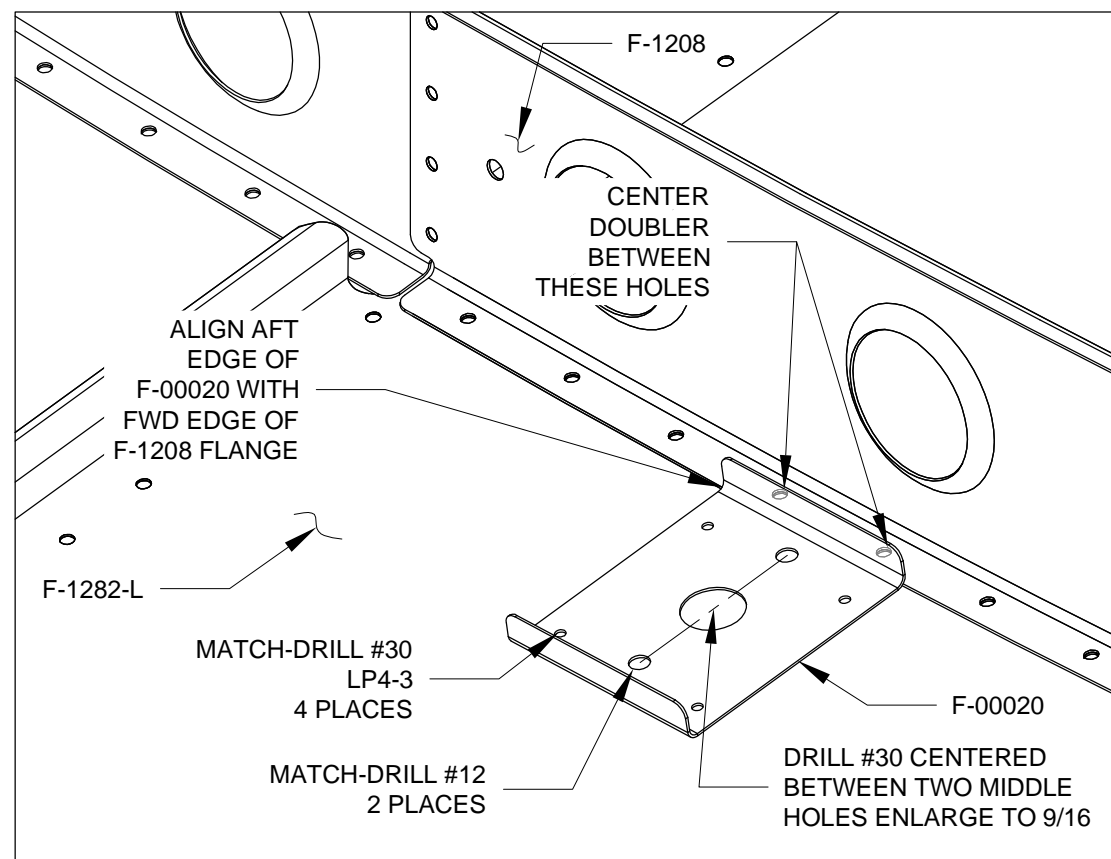

FIGURE 1: INSTALLING THE ANTENNA DOUBLER

Step 3: Drill #30 three holes in the web of the F-1208 Fuselage Frame for tie wraps (if not already punched in part). See Figures 2 and 4.

Deburr the three holes just drilled.

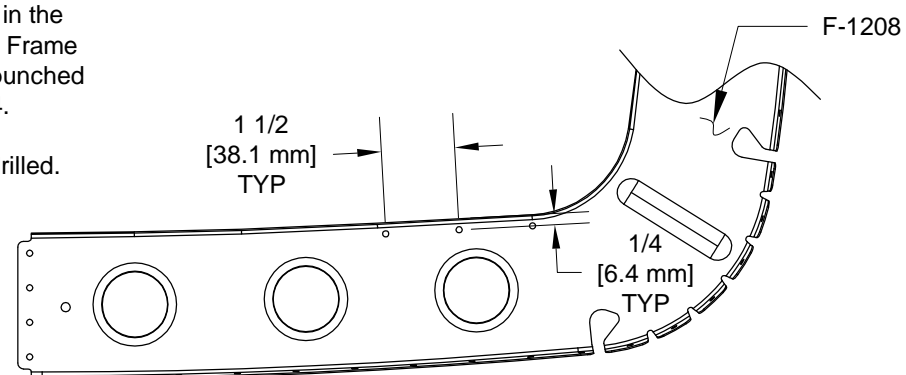

FIGURE 2: FUSELAGE FRAME TIE WRAP LOCATIONS

Step 4: Install the AV-00006 Blade ADS-B Antenna to the F-00020 Antenna Doubler and F-1282-L Bottom Left Skin using the instructions and hardware supplied with the antenna. See Figure 3.

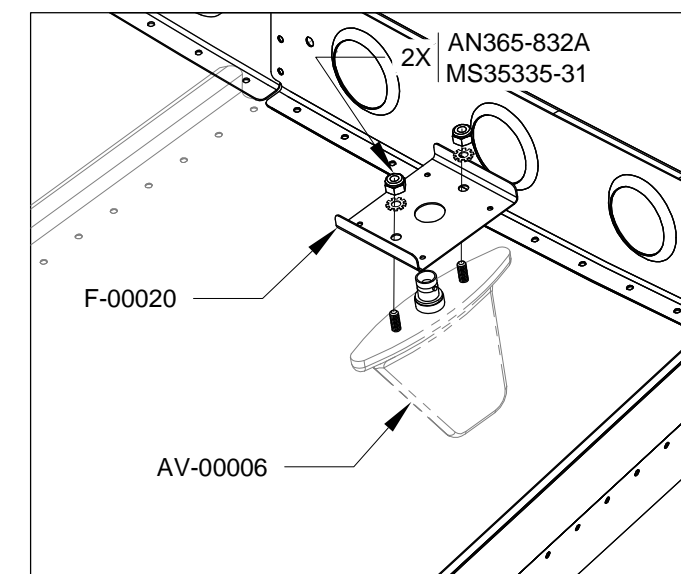

FIGURE 3: INSTALLING THE UAT ANTENNA (BOTTOM SKIN SHOWN TRANSPARENT)

Step 5: Connect the WH-00095 ADS-B Antenna Cable to the AV-00006 Blade ADS-B Antenna as shown in Figure 4.

Tie-wrap the cable to the F-1208 Fuselage Frame as shown in Figure 4.

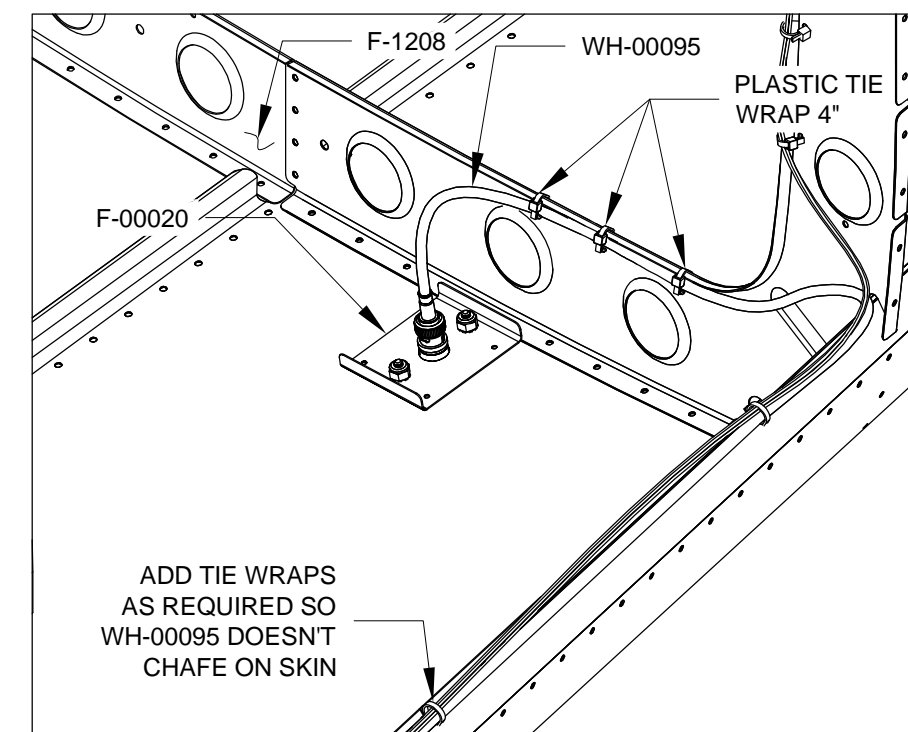
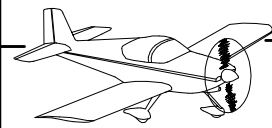

FIGURE 4: ROUTING THE ANTENNA CABLE



Step 2: Install a second fuse in the F-12123 Fuse Holder Assembly pertaining to the same fuse value shown in Figure 2.

Step 1: Install fuse called out in the AV-50001 Power & Switch Module as shown in Figure 1.

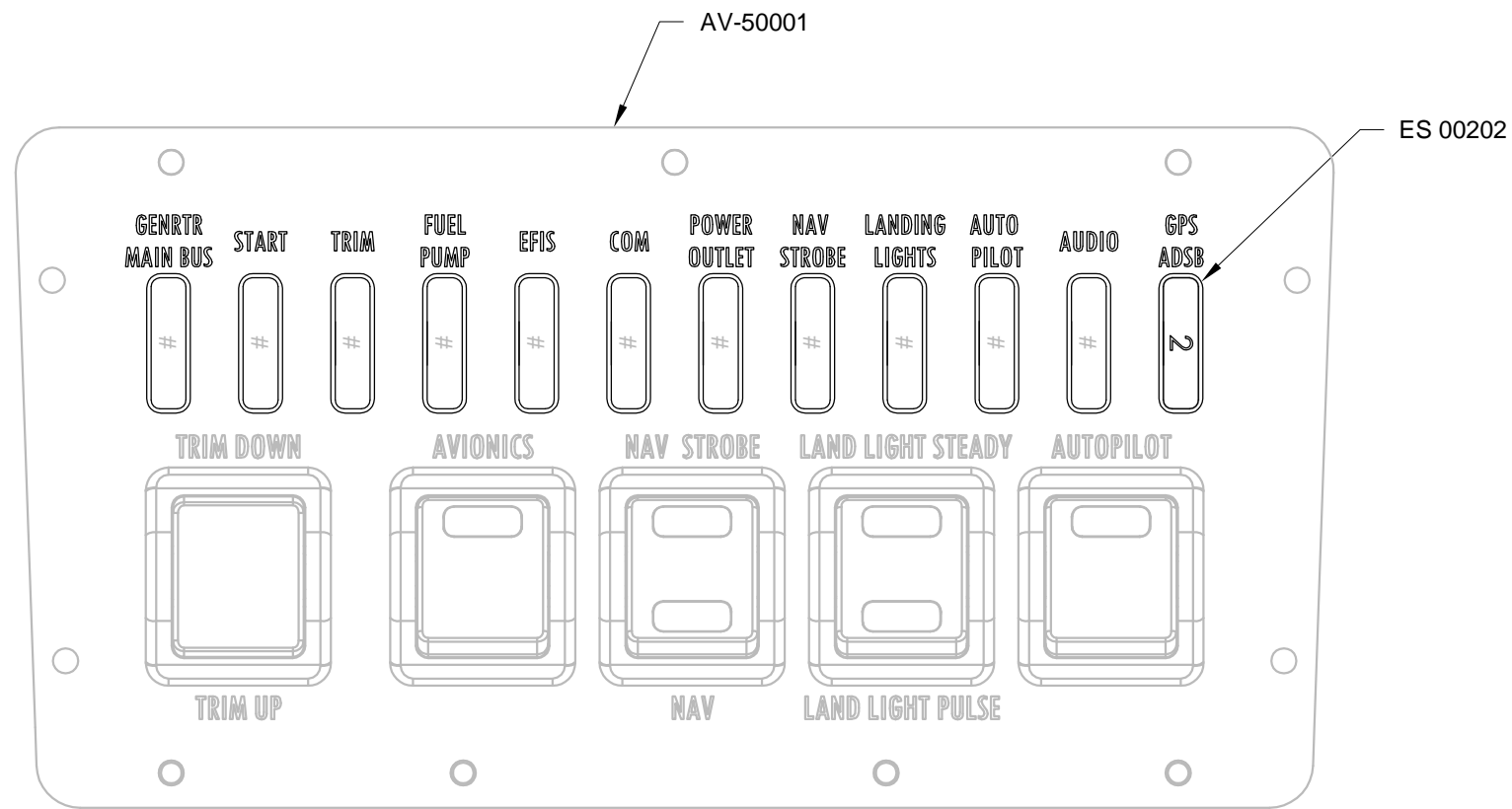

FIGURE 1: INSTALLING FUSE

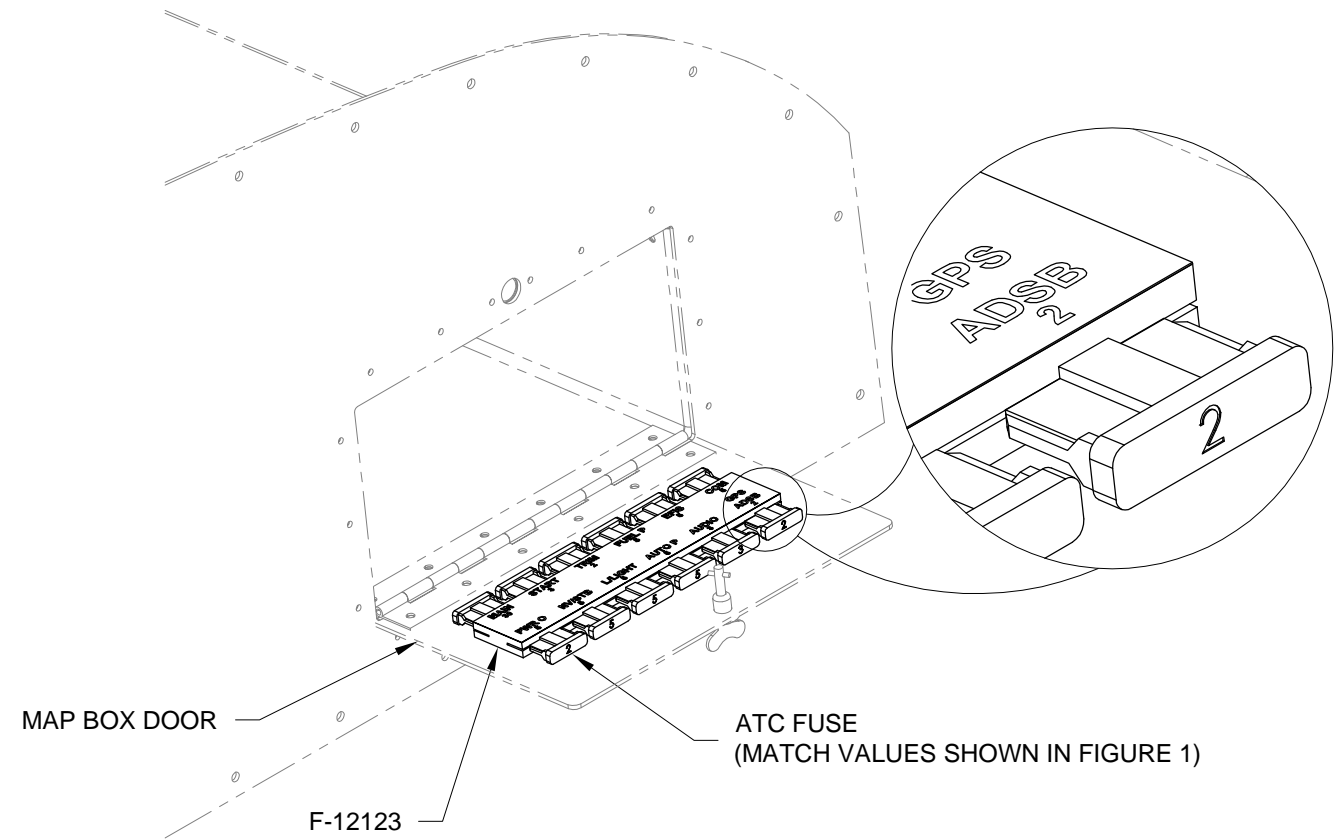

FIGURE 2: ADDING TO THE FUSE HOLDER



NOTE: The remaining steps on this page apply only if the WH-00049 ADS-B Antenna Cable was not previously installed. See Section 31B.

Step 1: The bend near the radius cut on the F-00050 Wire Routing Bracket may need to be adjusted using a vice and a plastic hammer or with a hand seamer as called out in Figure 1. This bend affects the placement of the attachment holes.

Use a bench vice or hand seamer to bend up the Wire Routing Bracket flanges as shown in Figure 1.

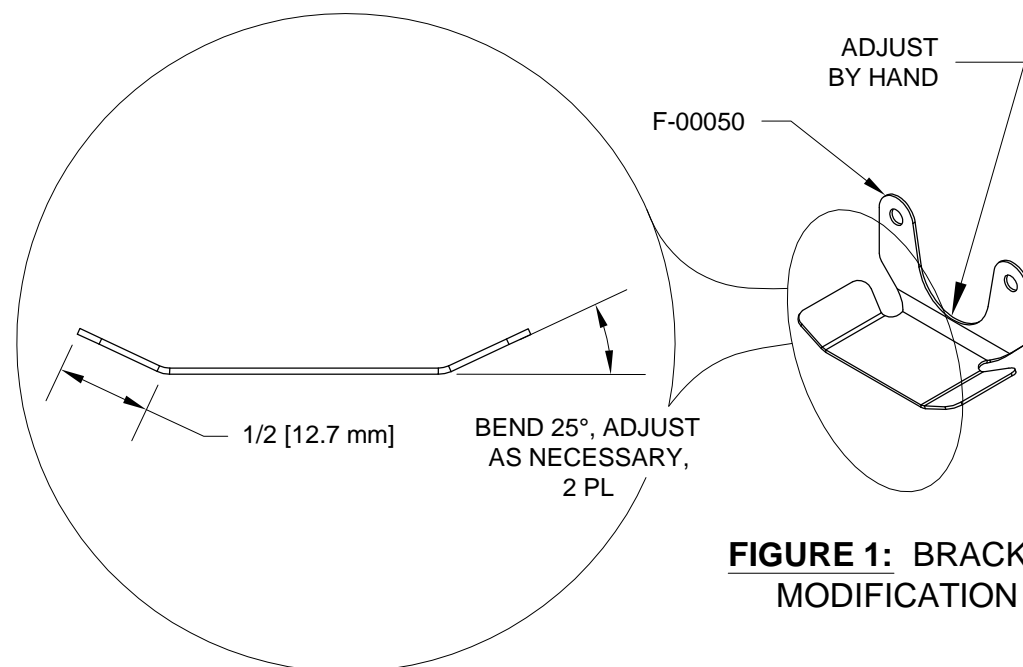

FIGURE 1: BRACKET MODIFICATION

Step 3: Attach the Flaperon Pushrod Assemblies per Section 32, and install the F-1230 Tunnel Cover, Detent Bracket Assembly, and F-1206E Baggage Cover per Section 33.

Step 4: Re-Install the F-1207F Baggage Bulkhead Corrugation per Section 33.

Re-Install the F-1276B Cover Plates and Fuel Tank Assembly per Section 37.

Re-Install the Seats and Seat Backs per Section 33 and Section 26.

Connect the WH-P149 (WHT) Battery Ground Cable to the negative battery terminal per Section 45A.

Install the F-1240 Upper Forward Fuselage Skin per Section 29A.

Attach the Top Cowl per Section 38.

Step 2: Secure the Flap Handle/ Pushrod Assembly and F-00050 Wire Routing Bracket to the inboard F-1215-L & -R Seat Ribs as shown in Figure 2. Use the F-1262 Flap Handle Blocks and the hardware called out in Section 32.

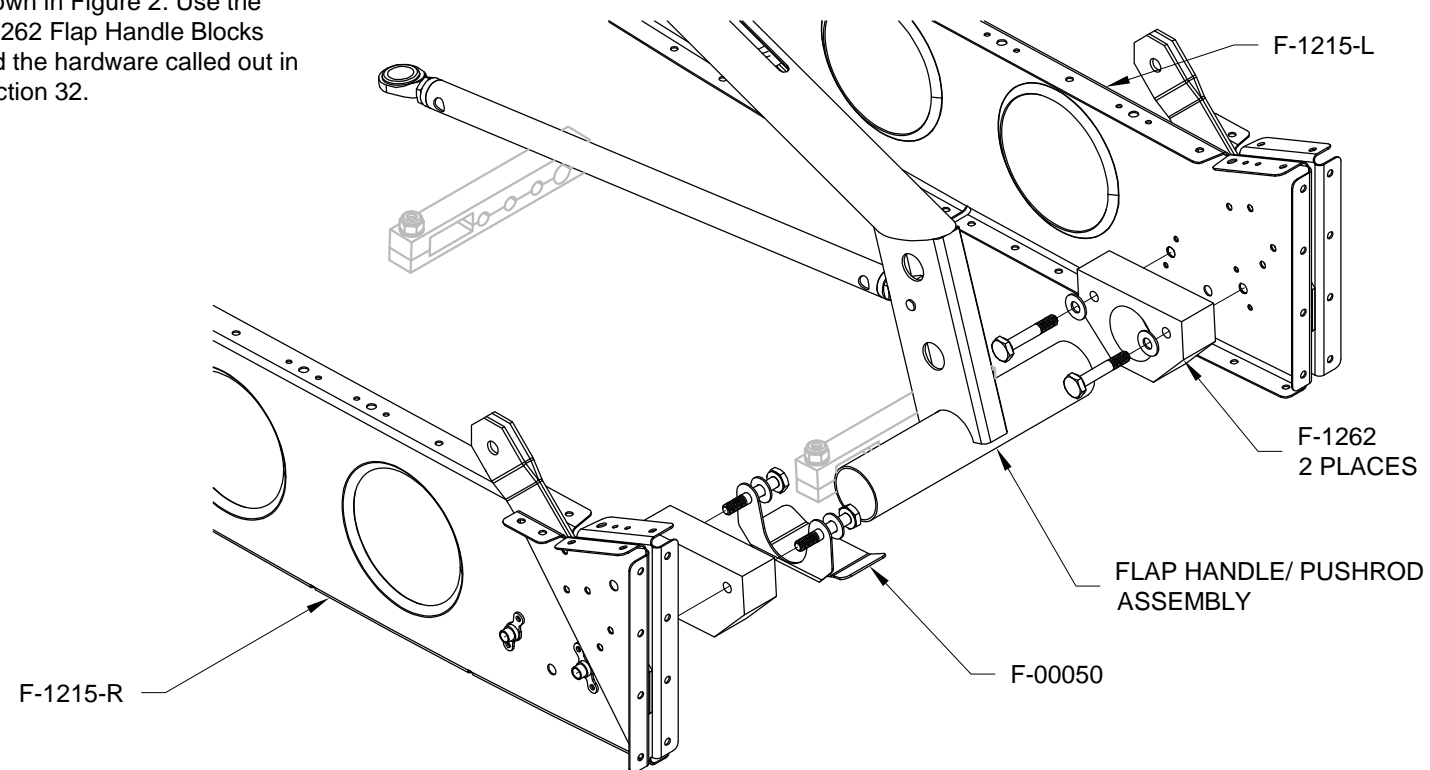
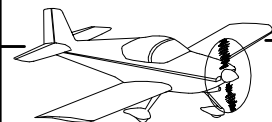

FIGURE 2: INSTALLING THE FLAP HANDLE/ PUSHROD ASSEMBLY



Step 1: Download and read the latest SV-PRE-SETS-READ-ME-MM-DD-YY.pdf read-me file.

Download and install the latest firmware and settings file from the downloads page of the Van's Aircraft web site.

Download and install from the same location the RV-12 ADS-B pre-sets file for the type ADS-B unit you are installing (the 470 or 472).

Step 2 (Updating Transponder Firmware): Follow the steps found in the Transponder section of the SV-PRE-SETS-READ-ME-MM-DD-YY.pdf read-me file.

Step 3: Download the latest RV-12 overall electrical schematic from the Van's Aircraft web site.

NOTE: Any weight and balance information recorded for the aircraft must be updated. Depending on the state of your kit some steps may not be applicable.

Step 4 (ADS-B 470): In the RV-12 Maintenance Manual (MM) "INSTALLED EQUIPMENT LIST" table, add "ADS-B 470" to the "ITEM" column. On the same line add a checkmark to the "INSTALLED" column.

Enter 1.89 lb for "Weight", 76.07 in for "Location/Arm" and 143.78 in-lb "Moment" onto the same line as "ADS-B 470".

Step 4 (ADS-B 472): In the RV-12 Maintenance Manual (MM) "INSTALLED EQUIPMENT LIST" table, add "ADS-B 472" to the "ITEM" column. On the same line add a checkmark to the "INSTALLED" column.

Enter 1.36 lb for "Weight", 85.4 in for "Location/Arm" and 116.15 in-lb "Moment" onto the same line as "ADS-B 472".

NOTE: Steps 5-7 on this page are only applicable if a final weight and balance as specified in the PAP has been completed

Step 5: In the RV-12 Pilot Operating Handbook (POH) "YOUR AIRPLANE" table, enter the new total values for the arm, weight, and moment of the installed equipment.

Step 6: In the RV-12 POH "YOUR AIRPLANE" table, recalculate and enter new values for the Empty Weight, Empty Moment, and Empty Arm.

Step 7: Make an entry, as calculated in the previous step, on the WEIGHT AND BALANCE RECORD page of the RV-12 Maintenance Manual as follows:

As of this date: ___/___/___ the following values represent current Weight and Balance calculations resulting from the installation of the ADS-B Optional Kit.

Revised Empty Weight: _____ lbs

Revised Empty Moment: _____ in-lbs

Revised Empty Arm: _____ in

Signed: _____

NOTE: The remaining steps on this page are only applicable for aircraft which have passed a final airworthiness inspection.

Step 8 (ELSA): Make an appropriate entry in the airframe logbook. See example below:

Installed the ADS-B option in accordance with Van's Aircraft KAI Section 53 and confirmed proper operation.

Signature _____ Certificate # _____

Step 8 (SLSA): Complete the notification N 16-07-28 (available from the Van's Aircraft web site) corresponding to the ADS-B installation.

Step 9: Section complete.